

Base Cabinet Scribes & Fillers

End Scribes

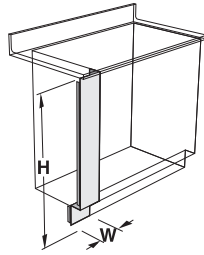

To close opening between wall and front of adjacent base cabinets. Includes detached toe space scribe and wall angle.

Sitting Height — 30" High

BESM310001-0000	1"W
BESM310006-0000	6"W
BESM310012-0000	12"W

ADA Height — 33" High

BESM340001-0000	1"W
BESM340006-0000	6"W
BESM340012-0000	12"W

Standing Height — 35¾" High

BESM370001-0000	1"W
BESM370006-0000	6"W
BESM370012-0000	12"W

End Scribe Applique Panels

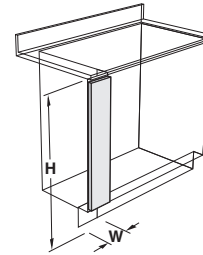

End Applique Panels may be used with End Scribes to match the face of doors and drawer heads on full overlay steel cabinets.

End Scribe must be ordered separately

Sitting Height — 30" High

Steel Square Edge	Steel Radius Edge	Oak Square Edge	Maple Square Edge	
BEAM310006-1100	not available	BEAM310006-1601	BEAM310006-1602	6"W
BEAM310012-1100	BEAM310012-1400	BEAM310012-1601	BEAM310012-1602	12"W

ADA Height — 33" High — Steel

Steel Square Edge	Steel Radius Edge	Oak Square Edge	Maple Square Edge	
BEAM340006-1100	not available	BEAM340006-1601	BEAM340006-1602	6"W
BEAM340012-1100	BEAM340012-1400	BEAM340012-1601	BEAM340012-1602	12"W

Standing Height — 35¾" High — Steel

Steel Square Edge	Steel Radius Edge	Oak Square Edge	Maple Square Edge	
BEAM370006-1100	not available	BEAM370006-1601	BEAM370006-1602	6"W
BEAM370012-1100	BEAM370012-1400	BEAM370012-1601	BEAM370012-1602	12"W

Intermediate Fillers

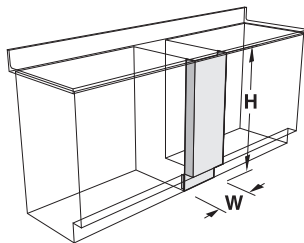

To close opening between two adjacent base cabinets. Includes detached toe space filler.

Sitting Height — 30" High

BIFM310001-0000	1"W
BIFM310002-0000	2"W
BIFM310004-0000	4"W
BIFM310005-0000	5"W
BIFM310006-0000	6"W
BIFM310018-0000	18"W

ADA Height — 33" High

BIFM340001-0000	1"W
BIFM340002-0000	2"W
BIFM340004-0000	4"W
BIFM340005-0000	5"W
BIFM340006-0000	6"W
BIFM340018-0000	18"W

Standing Height — 35¾" High

BIFM370001-0000	1"W
BIFM370002-0000	2"W
BIFM370004-0000	4"W
BIFM370005-0000	5"W
BIFM370006-0000	6"W
BIFM370018-0000	18"W

Intermediate Applique Panels

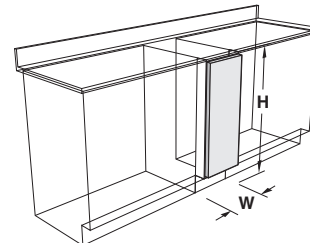

Intermediate Applique Panels may be used with Intermediate Fillers to match the face of doors and drawer heads on full overlay steel cabinets.

Intermediate Filler must be ordered separately

Sitting Height — 30" High

Steel Square Edge	Steel Radius Edge	Oak Square Edge	Maple Square Edge	
BIAM310004-1100	not available	BIAM310004-1601	BIAM310004-1602	4"W
BIAM310005-1100	not available	BIAM310005-1601	BIAM310005-1602	5"W
BIAM310006-1100	not available	BIAM310006-1601	BIAM310006-1602	6"W
BIAM310018-1100	BIAM310018-1400	BIAM310018-1601	BIAM310018-1602	18"W

ADA Height — 33" High

Steel Square Edge	Steel Radius Edge	Oak Square Edge	Maple Square Edge	
BIAM340004-1100	not available	BIAM340004-1601	BIAM340004-1602	4"W
BIAM340005-1100	not available	BIAM340005-1601	BIAM340005-1602	5"W
BIAM340006-1100	not available	BIAM340006-1601	BIAM340006-1602	6"W
BIAM340018-1100	BIAM340018-1400	BIAM340018-1601	BIAM340018-1602	18"W

Standing Height — 35¾" High

Steel Square Edge	Steel Radius Edge	Oak Square Edge	Maple Square Edge	
BIAM370004-1100	not available	BIAM370004-1601	BIAM370004-1602	4"W
BIAM370005-1100	not available	BIAM370005-1601	BIAM370005-1602	5"W
BIAM370006-1100	not available	BIAM370006-1601	BIAM370006-1602	6"W
BIAM370018-1100	BIAM370018-1400	BIAM370018-1601	BIAM370018-1602	18"W

Base Cabinet Scribes & Fillers

Corner Fillers

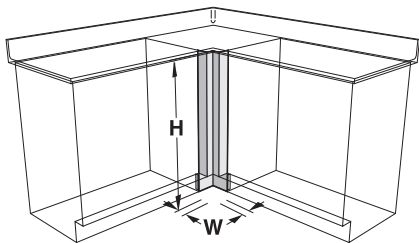

To close opening between two adjacent base cabinets joined at right angles. Includes detached toe space filler.

Sitting Height — 30" High	
BCFM310001-0000	1"W
BCFM310002-0000	2"W
BCFM310003-0000	3"W
BCFM310004-0000	4"W
BCFM310005-0000	5"W
BCFM310006-0000	6"W

ADA Height — 33" High	
BCFM340001-0000	1"W
BCFM340002-0000	2"W
BCFM340003-0000	3"W
BCFM340004-0000	4"W
BCFM340005-0000	5"W
BCFM340006-0000	6"W

Standing Height — 35¾" High	
BCFM370001-0000	1"W
BCFM370002-0000	2"W
BCFM370003-0000	3"W
BCFM370004-0000	4"W
BCFM370005-0000	5"W
BCFM370006-0000	6"W

Corner Applique Panels

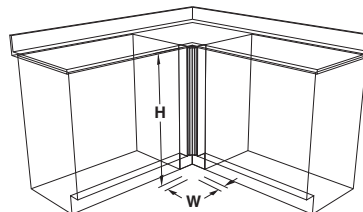

Corner Applique Panels may be used with Corner Fillers to match the face of doors and drawer heads on full overlay steel cabinets.

Corner Filler must be ordered separately

Sitting Height — 30" High				
Steel Square Edge	Steel Radius Edge	Oak Square Edge	Maple Square Edge	

BCAM310003-1100	not available	BCAM310003-1601	BCAM310003-1602	3"W
BCAM310006-1100	not available	BCAM310006-1601	BCAM310006-1602	6"W

ADA Height — 33" High				
Steel Square Edge	Steel Radius Edge	Oak Square Edge	Maple Square Edge	

BCAM340003-1100	not available	BCAM340003-1601	BCAM340003-1600	3"W
BCAM340006-1100	not available	BCAM340006-1601	BCAM340006-1602	6"W

Standing Height — 35¾" High				
Steel Square Edge	Steel Radius Edge	Oak Square Edge	Maple Square Edge	

BCAM370003-1100	not available	BCAM370003-1601	BCAM370003-1602	3"W
BCAM370006-1100	not available	BCAM370006-1601	BCAM370006-1602	6"W

Rear Scribes

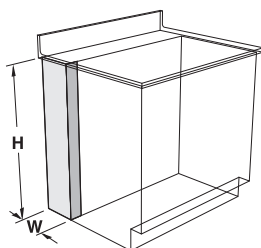

To close opening between wall and rear of adjacent base cabinet. Includes wall mounting angle.

Sitting Height 30" High	ADA Height 33" High	Standing Height 35¾" High	
BRSM310001-0000	BRSM340001-0000	BRSM370001-0000	1"W
BRSM310002-0000	BRSM340002-0000	BRSM370002-0000	2"W
BRSM310004-0000	BRSM340004-0000	BRSM370004-0000	4"W
BRSM310007-0000	BRSM340007-0000	BRSM370007-0000	7"W
BRSM310008-0000	BRSM340008-0000	BRSM370008-0000	8"W
BRSM310010-0000	BRSM340010-0000	BRSM370010-0000	10"W

Pipe Chase Fillers

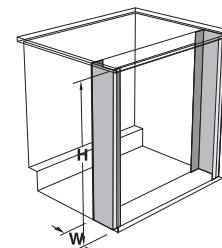
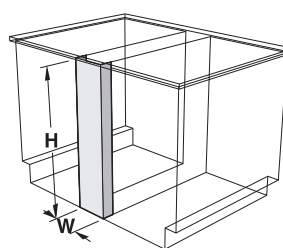

To close opening between two adjacent base cabinets installed back-to-back. May also be used with a finished back to create a pipe chase behind a free standing cabinet to create a single-sided island or peninsula.

Sitting Height 30" High	ADA Height 33" High	Standing Height 35¾" High	
BPCM310002-0000	BPCM340002-0000	BPCM370002-0000	2"W
BPCM310007-0000	BPCM340007-0000	BPCM370007-0000	7"W
BPCM310008-0000	BPCM340008-0000	BPCM370008-0000	8"W
BPCM310014-0000	BPCM340014-0000	BPCM370014-0000	14"W
BPCM310016-0000	BPCM340016-0000	BPCM370016-0000	16"W
BPCM310020-0000	BPCM340020-0000	BPCM370020-0000	20"W

Wall Cabinet Scribes & Fillers

End Scribes

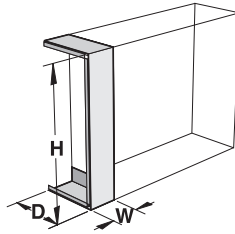

To close opening between wall and front of adjacent wall cabinet. Includes wall mounting angles.

24" High

12³/₄" Deep

16" Deep

WESM241301-0000	WESM241601-0000	1"W
WESM241306-0000	WESM241606-0000	6"W
WESM241312-0000	WESM241612-0000	12"W

30" High

12³/₄" Deep

16" Deep

WESM301301-0000	WESM301601-0000	1"W
WESM301306-0000	WESM301606-0000	6"W
WESM301312-0000	WESM301612-0000	12"W

36" High

12³/₄" Deep

16" Deep

WESM361301-0000	WESM361601-0000	1"W
WESM361306-0000	WESM361606-0000	6"W
WESM361312-0000	WESM361612-0000	12"W

47" High

12³/₄" Deep

16" Deep

WESM471301-0000	WESM471601-0000	1"W
WESM471306-0000	WESM471606-0000	6"W
WESM471312-0000	WESM471612-0000	12"W

End Scribe Applique Panel

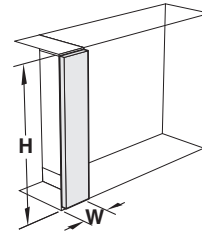

End Applique Panels may be used with End Scribes to match the face of doors and drawer heads on full overlay steel cabinets.

End Scribe must be ordered separately

24" High

Steel Square Edge

Steel Radius Edge

WEAM240006-1100	not available	6"W
WEAM240012-1100	WEAM240012-1400	12"W

24" High

Oak

Maple

WEAM240006-1601	WEAM240006-1602	6"W
WEAM240012-1601	WEAM240012-1602	12"W

30" High

Steel Square Edge

Steel Radius Edge

WEAM300006-1100	not available	6"W
WEAM300012-1100	WEAM300012-1400	12"W

30" High

Oak

Maple

WEAM300006-1601	WEAM300006-1602	6"W
WEAM300012-1601	WEAM300012-1602	12"W

36" High

Steel Square Edge

Steel Radius Edge

WEAM360006-1100	not available	6"W
WEAM360012-1100	WEAM360012-1400	12"W

36" High

Oak

Maple

WEAM360006-1601	WEAM360006-1602	6"W
WEAM360012-1601	WEAM360012-1602	12"W

47" High

Steel Square Edge

Steel Radius Edge

WEAM470006-1100	not available	6"W
WEAM470012-1100	WEAM470012-1400	12"W

47" High

Oak

Maple

WEAM470006-1601	WEAM470006-1602	6"W
WEAM470012-1601	WEAM470012-1602	12"W

Wall Cabinet Scribes & Fillers

Intermediate Fillers Intermediate Filler Applique Panel

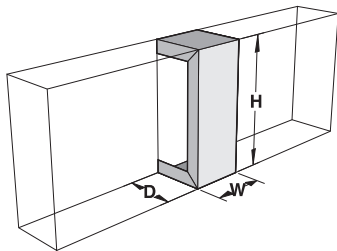

To close opening between two adjacent wall cabinets.

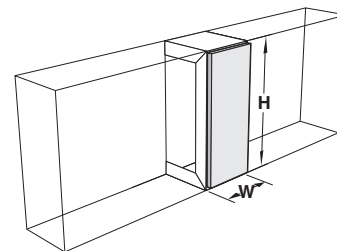

Intermediate Applique Panels may be used with Intermediate Fillers to match the face of doors and drawer heads on full overlay steel cabinets.

Intermediate Filler must be ordered separately

24" High		
12 ³ / ₄ " Deep	16" Deep	
WIFM241301-0000	WIFM241601-0000	1"W
WIFM241304-0000	WIFM241604-0000	4"W
WIFM241305-0000	WIFM241605-0000	5"W
WIFM241306-0000	WIFM241606-0000	6"W
WIFM241318-0000	WIFM241618-0000	18"W
WIFM241324-0000	WIFM241624-0000	24"W

30" High		
12 ³ / ₄ " Deep	16" Deep	
WIFM301301-0000	WIFM301601-0000	1"W
WIFM301304-0000	WIFM301604-0000	4"W
WIFM301305-0000	WIFM301605-0000	5"W
WIFM301306-0000	WIFM301606-0000	6"W
WIFM301318-0000	WIFM301618-0000	18"W
WIFM301324-0000	WIFM301624-0000	24"W

36" High		
12 ³ / ₄ " Deep	16" Deep	
WIFM361301-0000	WIFM361601-0000	1"W
WIFM361304-0000	WIFM361604-0000	4"W
WIFM361305-0000	WIFM361605-0000	5"W
WIFM361306-0000	WIFM361606-0000	6"W
WIFM361318-0000	WIFM361618-0000	18"W
WIFM361324-0000	WIFM361624-0000	24"W

47" High		
12 ³ / ₄ " Deep	16" Deep	
WIFM471301-0000	WIFM471601-0000	1"W
WIFM471304-0000	WIFM471604-0000	4"W
WIFM471305-0000	WIFM471605-0000	5"W
WIFM471306-0000	WIFM471606-0000	6"W
WIFM471318-0000	WIFM471618-0000	18"W
WIFM471324-0000	WIFM471624-0000	24"W

24" High		
Steel Square Edge	Steel Radius Edge	
WIAM240006-1100	not available	6"W
WIAM240018-1100	WIAM240018-1400	18"W
WIAM240024-1100	WIAM240024-1400	24"W

24" High		
Oak	Maple	
WIAM240006-1601	WIAM240006-1602	6"W
WIAM240018-1601	WIAM240018-1602	18"W
WIAM240024-1601	WIAM240024-1602	24"W

30" High — Steel		
Steel Square Edge	Steel Radius Edge	
WIAM300006-1100	not available	6"W
WIAM300018-1100	WIAM300018-1400	18"W
WIAM300024-1100	WIAM300024-1400	24"W

30" High — Steel		
Oak	Maple	
WIAM300006-1601	WIAM300006-1602	6"W
WIAM300018-1601	WIAM300018-1602	18"W
WIAM300024-1601	WIAM300024-1602	24"W

36" High		
Steel Square Edge	Steel Radius Edge	
WIAM360006-1100	not available	6"W
WIAM360018-1100	WIAM360018-1400	18"W
WIAM360024-1100	WIAM360024-1400	24"W

36" High		
Oak	Maple	
WIAM360006-1601	WIAM360006-1602	6"W
WIAM360018-1601	WIAM360018-1602	18"W
WIAM360024-1601	WIAM360024-1602	24"W

47" High		
Steel Square Edge	Steel Radius Edge	
WIAM470006-1100	not available	6"W
WIAM470018-1100	WIAM470018-1400	18"W
WIAM470024-1100	WIAM470024-1400	24"W

47" High		
Oak	Maple	
WIAM470006-1601	WIAM470006-1602	6"W
WIAM470018-1601	WIAM470018-1602	18"W
WIAM470024-1601	WIAM470024-1602	24"W

Wall Cabinet Fillers & Scribes

Corner Fillers

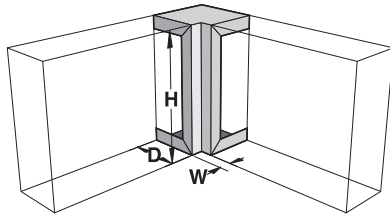

To close opening between two adjacent wall cabinets joined at right angles.

24" High

12³/₄" Deep

16" Deep

WCFM241301-0000	WCFM241601-0000	1"W
WCFM241302-0000	WCFM241602-0000	2"W
WCFM241303-0000	WCFM241603-0000	3"W
WCFM241304-0000	WCFM241604-0000	4"W
WCFM241365-0000	WCFM241605-0000	5"W
WCFM241306-0000	WCFM241606-0000	6"W

30" High

12³/₄" Deep

16" Deep

WCFM301301-0000	WCFM301601-0000	1"W
WCFM301302-0000	WCFM301602-0000	2"W
WCFM301303-0000	WCFM301603-0000	3"W
WCFM301304-0000	WCFM301604-0000	4"W
WCFM301305-0000	WCFM301605-0000	5"W
WCFM301306-0000	WCFM301606-0000	6"W

36" High

12³/₄" Deep

16" Deep

WCFM361301-0000	WCFM361601-0000	1"W
WCFM361302-0000	WCFM361602-0000	2"W
WCFM361303-0000	WCFM361603-0000	3"W
WCFM361304-0000	WCFM361604-0000	4"W
WCFM361305-0000	WCFM361605-0000	5"W
WCFM361306-0000	WCFM361605-0000	6"W

47" High

12³/₄" Deep

16" Deep

WCFM471301-0000	WCFM471601-0000	1"W
WCFM471302-0000	WCFM471602-0000	2"W
WCFM471303-0000	WCFM471603-0000	3"W
WCFM471304-0000	WCFM471604-0000	4"W
WCFM471305-0000	WCFM471605-0000	5"W
WCFM471306-0000	WCFM471606-0000	6"W

Corner Fillers Applique Panel

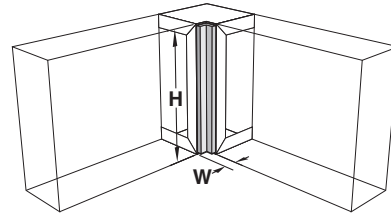

Corner Applique Panels may be used with Corner Fillers to match the face of doors and drawer heads on full overlay steel cabinets.

Corner Filler must be ordered separately

24" High

Steel Square Edge

Steel Radius Edge

WCAM240003-1100	not available	3"W
WCAM240006-1100	not available	6"W

24" High

Oak

Maple

WCAM240003-1601	WCAM240003-1602	2"W
WCAM240006-1601	WCAM240006-1602	6"W

30" High

Steel Square Edge

Steel Radius Edge

WCAM300003-1100	not available	3"W
WCAM300006-1100	not available	6"W

30" High

Oak

Maple

WCAM300003-1601	WCAM300003-1602	3"W
WCAM300006-1601	WCAM300006-1602	6"W

36" High

Steel Square Edge

Steel Radius Edge

WCAM360003-1100	not available	3"W
WCAM360006-1100	not available	6"W

36" High

Oak

Maple

WCAM360003-1601	WCAM360003-1602	3"W
WCAM360006-1601	WCAM360006-1602	6"W

47" High

Steel Square Edge

Steel Radius Edge

WIAM470003-1100	not available	3"W
WIAM470006-1100	not available	6"W

47" High

Oak

Maple

WCAM470003-1601	WCAM470003-1602	3"W
WCAM470006-1601	WCAM470006-1602	6"W

Full Height Cabinet Fillers & Scribes

Full Height End Scribes

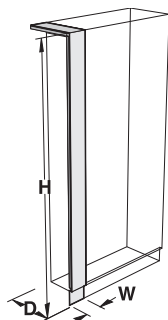

To close opening between wall and front of adjacent full height cabinets. Includes detached toe space scribe and wall mounting angles.

12³/₄" Deep

FESM841301-0000	1"W
FESM841306-0000	6"W
FESM841312-0000	12"W

16" Deep

FESM841601-0000	1"W
FESM841606-0000	6"W
FESM841612-0000	12"W

22" Deep

FESM842201-0000	1"W
FESM842206-0000	6"W
FESM842212-0000	12"W

Full Height End Applique Panel

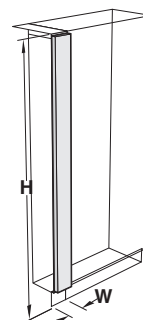

End Applique Panels may be used with End Scribes to match the face of doors and drawer heads on full overlay steel cabinets.

End Scribe must be ordered separately

Steel Square Edge	Steel Radius Edge	
FEAM840006-1100	not available	6"W
FEAM840012-1100	FEAM840012-1400	12"W

Oak	Maple	
FEAM840006-1601	FEAM840006-1602	6"W
FEAM840012-1601	FEAM840012-1602	12"W

Full Height Intermediate Fillers

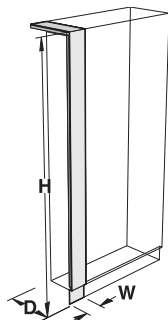

To close opening between two adjacent full height cabinets. Includes detached toe space filler.

12³/₄" Deep

FIFM841301-0000	1"W
FIFM841306-0000	6"W
FIFM841312-0000	12"W

16" Deep

FIFM841601-0000	1"W
FIFM841606-0000	6"W
FIFM841612-0000	12"W

22" Deep

FIFM842201-0000	1"W
FIFM842206-0000	6"W
FIFM842212-0000	12"W

Full Height Intermediate Applique Panel

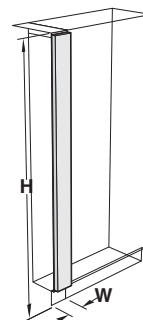

Intermediate Applique Panels may be used with Intermediate Fillers to match the face of doors and drawer heads on full overlay steel cabinets.

Intermediate Fillers must be ordered separately

Steel Square Edge	Steel Radius Edge	
FIAM840006-1100	not available	6"W
FIAM840012-1100	FIAM840012-1400	12"W

Oak	Maple	
FIAM840006-1601	FIAM840006-1602	6"W
FIAM840012-1601	FIAM840012-1602	12"W

Full Height Cabinet Fillers, Scribes & Panels

Corner Filler

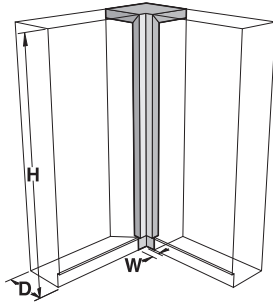

To close opening between two adjacent full height cabinets joined at right angles. Includes detached toe space filler.

12³/₄" Deep

FCFM841301-0000	1"W
FCFM841303-0000	3"W
FCFM841306-0000	6"W

16" Deep

FCFM841601-0000	1"W
FCFM841603-0000	3"W
FCFM841606-0000	6"W

22" Deep

FCFM842201-0000	1"W
FCFM842203-0000	3"W
FCFM842206-0000	6"W

Corner Fillers Applique Panel

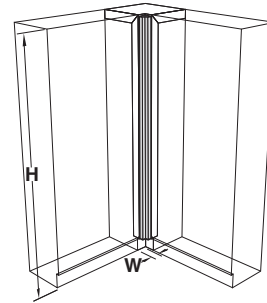

Corner Applique Panels may be used with Corner Fillers to match the face of doors and drawer heads on full overlay steel cabinets.

Corner Filler must be ordered separately

Steel Square Edge	Steel Radius Edge	
FCAM840003-1100	not available	3"W
FCAM840006-1100	not available	6"W
Oak	Maple	
FCAM840003-1601	FCAM840003-1602	3"W
FCAM840006-1601	FCAM840006-1602	6"W

Full Height Rear Scribe

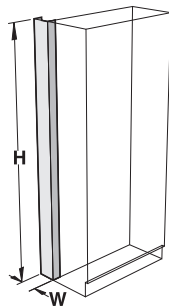

To close opening between wall and rear of adjacent full height cabinets.

56" High

FRSM560001-0000	1"W
FRSM560004-0000	4"W
FRSM560007-0000	7"W
FRSM560008-0000	8"W

84" High

FRSM840001-0000	1"W
FRSM840004-0000	4"W
FRSM840007-0000	7"W
FRSM840008-0000	8"W

Full Height Finished Back

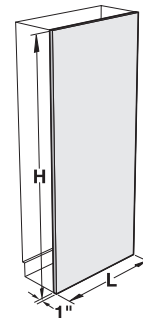

To cover backs of full height cabinets exposed to view. Adds 1" to depth of cabinet.

84" High

FFBM840118-0000	18"W
FFBM840124-0000	24"W
FFBM840130-0000	30"W
FFBM840136-0000	36"W
FFBM840142-0000	42"W
FFBM840148-0000	48"W

Steel Cabinet Finished Backs

Base Cabinet Finished Back

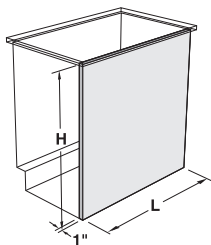

To cover backs of base cabinets exposed to view. Back adds 1" to the depth of the base cabinet.

Sitting Height — 30" High

BFBM310112-0000	12"W
BFBM310115-0000	18"W
BFBM310118-0000	18"W
BFBM310121-0000	21"W
BFBM310124-0000	24"W
BFBM310130-0000	30"W
BFBM310136-0000	36"W
BFBM310142-0000	42"W
BFBM310148-0000	48"W
BFBM310160-0000	60"W

ADA Height — 33" High

BFBM340112-0000	12"W
BFBM340115-0000	15"W
BFBM340118-0000	18"W
BFBM340121-0000	21"W
BFBM340124-0000	24"W
BFBM340130-0000	30"W
BFBM340136-0000	36"W
BFBM340142-0000	42"W
BFBM340148-0000	48"W
BFBM340160-0000	60"W

Standing Height — 35¾" High

BFBM370112-0000	12"W
BFBM370115-0000	15"W
BFBM370118-0000	18"W
BFBM370121-0000	21"W
BFBM370124-0000	24"W
BFBM370130-0000	30"W
BFBM370136-0000	36"W
BFBM370142-0000	42"W
BFBM370148-0000	48"W
BFBM370160-0000	60"W

Wall Cabinet Finished Back

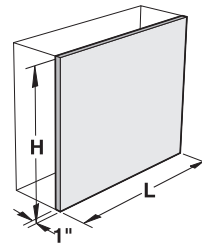

To cover backs of wall cabinets exposed to view. Adds 1" to depth of cabinet.

24" High

WFBM240115-0000	15"W
WFBM240118-0000	18"W
WFBM240121-0000	21"W
WFBM240124-0000	24"W
WFBM240130-0000	30"W
WFBM240136-0000	36"W
WFBM240142-0000	42"W
WFBM240148-0000	48"W

30" High

WFBM300115-0000	15"W
WFBM300118-0000	18"W
WFBM300121-0000	21"W
WFBM300124-0000	24"W
WFBM300130-0000	30"W
WFBM300136-0000	36"W
WFBM300142-0000	42"W
WFBM300148-0000	48"W

36" High

WFBM360115-0000	15"W
WFBM360118-0000	18"W
WFBM360121-0000	21"W
WFBM360124-0000	24"W
WFBM360130-0000	30"W
WFBM360136-0000	36"W
WFBM360142-0000	42"W
WFBM360148-0000	48"W

47" High

WFBM470115-0000	15"W
WFBM470118-0000	18"W
WFBM470121-0000	21"W
WFBM470124-0000	24"W
WFBM470130-0000	30"W
WFBM470136-0000	36"W
WFBM470142-0000	42"W
WFBM470148-0000	48"W

Steel Sloping Tops & Ceiling Enclosures

Sloping Tops

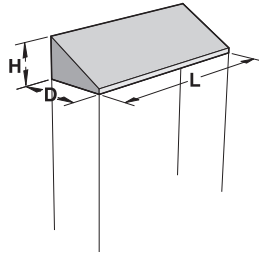

May be used on wall cabinets and full height cabinets to keep the tops dust free.

8 ³ / ₈ " High 12 ³ / ₄ " Deep	10 ³ / ₄ " High 16" Deep	13 ³ / ₄ " High 22" Deep	
SLTM081315-0000	SLTM111615-0000	SLTM142215-0000	15"L
SLTM081318-0000	SLTM111618-0000	SLTM142218-0000	18"L
SLTM081321-0000	SLTM111621-0000	SLTM142221-0000	21"L
SLTM081324-0000	SLTM111624-0000	SLTM142224-0000	24"L
SLTM081330-0000	SLTM111630-0000	SLTM142230-0000	30"L
SLTM081336-0000	SLTM111636-0000	SLTM142236-0000	36"L
SLTM081342-0000	SLTM111642-0000	SLTM142242-0000	42"L
SLTM081348-0000	SLTM111648-0000	SLTM142248-0000	48"L
SLTM081360-0000	SLTM111660-0000	SLTM142260-0000	60"L
SLTM081372-0000	SLTM111672-0000	SLTM142272-0000	72"L
SLTM081384-0000	SLTM111684-0000	SLTM142284-0000	84"L
SLTM081396-0000	SLTM111696-0000	SLTM142296-0000	96"L

Sloping Top Fillers

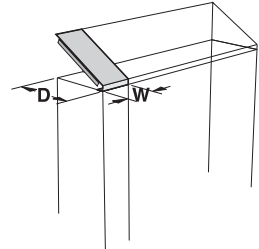

To close opening between wall and front of adjacent sloping top. Includes wall mounting angle.

8 ³ / ₈ " High 12 ³ / ₄ " Deep	10 ³ / ₄ " High 16" Deep	13 ³ / ₄ " High 22" Deep	
STFM081301-0000	STFM111601-0000	STFM142201-0000	1"W
STFM081306-0000	STFM111606-0000	STFM142206-0000	6"W
STFM081312-0000	STFM111612-0000	STFM142212-0000	12"W

Sloping Top Corner Fillers

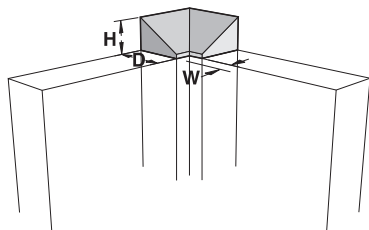

May be used on wall cabinets and full height cabinets when cabinets are joined at right angles.

8 ³ / ₈ " High 12 ³ / ₄ " Deep	10 ³ / ₄ " High 16" Deep	13 ³ / ₄ " High 22" Deep	
SCFM081301-0000	SCFM111601-0000	SCFM142201-0000	1"W
SCFM081306-0000	SCFM111606-0000	SCFM142206-0000	6"W

Ceiling Enclosures

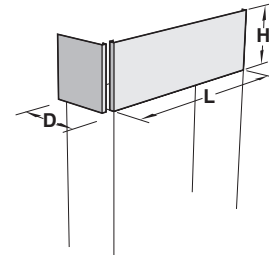

To close opening between ceiling and top of wall or full height cabinets.

Front Ceiling Enclosure

12" High	24" High	
FCEM120018-0000	FCEM240018-0000	18"L
FCEM120024-0000	FCEM240024-0000	24"L
FCEM120030-0000	FCEM240030-0000	30"L
FCEM120036-0000	FCEM240036-0000	36"L
FCEM120042-0000	FCEM240042-0000	42"L
FCEM120048-0000	FCEM240048-0000	48"L
FCEM120060-0000	FCEM240060-0000	60"L
FCEM120072-0000	FCEM240072-0000	72"L
FCEM120084-0000	FCEM240084-0000	84"L
FCEM120096-0000	FCEM240096-0000	96"L

End Ceiling Enclosure

12" High	24" High	
ECEM120013-0000	ECEM240013-0000	12 ³ / ₄ "D
ECEM120016-0000	ECEM240016-0000	16"D
ECEM120022-0000	ECEM240022-0000	22"D

Corner Ceiling Enclosures

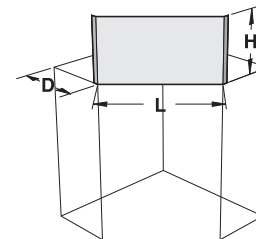

To close opening between ceiling and top of corner wall cabinets.

12" High	24" High	Depth	Length
CCEM121320-0000	CCEM241320-0000	12 ³ / ₄ "	20"
CCEM121615-0000	CCEM241615-0000	16"	15 ³ / ₈ "

Corner Cabinet Sloping Tops

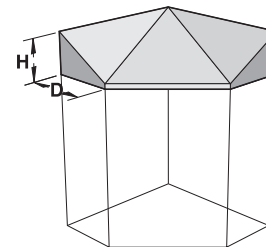

To be used on corner wall cabinets.

8 ³ / ₈ " High 12 ³ / ₄ " Deep	10 ³ / ₄ " High 16" Deep	
CSTM081327-0000	CSTM111627-0000	26 ⁷ / ₈ "L

Steel Adjustable Slip Scribes

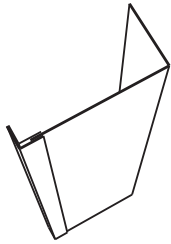

Specifications:

Steel Adjustable Slip Scribes are designed the same as standard scribes with the addition of a Slip-on Angle at the wall edge to dress-up the edge of the scribe.

The Steel Adjustable Slip Scribe is designed to be cut to width in the field to more easily fit the space between the wall and the end of the furniture assembly.

Base Cabinet Adjustable End Scribe

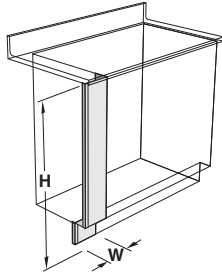

To close opening between wall and front of adjacent base cabinets. Includes detached toe space scribe and wall scribing angles.

Sitting Height — 30" High

ABSM310012-0000 12"W

ADA Height — 33" High

ABSM340012-0000 12"W

Standing Height — 35³/₄" High

ABSM370012-0000 12"W

Wall Cabinet Adjustable End Scribes

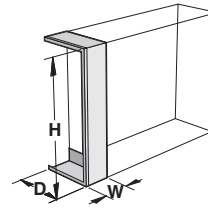

To close opening between wall and front of adjacent wall cabinet. Includes wall scribing angle.

12³/₄" Deep

16" Deep

24" High

AWSM241312-0000 12"W **AWSM241612-0000** 12"W

30" High

AWSM301312-0000 12"W **AWSM301612-0000** 12"W

36" High

AWSM361312-0000 12"W **AWSM361612-0000** 12"W

47" High

AWSM471312-0000 12"W **AWSM471612-0000** 12"W

Full Height Cabinet Adjustable End Scribes

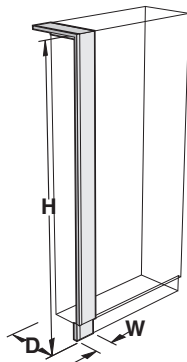

To close opening between wall and front of adjacent full height cabinets. Includes detached toe space scribe and wall scribing angles.

12³/₄" Deep

AFSM841312-0000 12"W

16" Deep

AFSM841612-0000 12"W

22" Deep

AFSM842212-0000 12"W