

# Base Cabinet Scribes & Fillers

## End Scribes

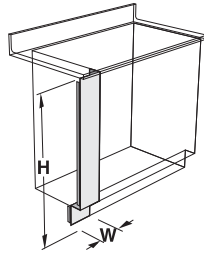

To close opening between wall and front of adjacent base cabinets. Includes detached toe space scribe and wall angle.

### Sitting Height — 30" High

<b>BESM310001-0000</b>	1"W
<b>BESM310006-0000</b>	6"W
<b>BESM310012-0000</b>	12"W

### ADA Height — 33" High

<b>BESM340001-0000</b>	1"W
<b>BESM340006-0000</b>	6"W
<b>BESM340012-0000</b>	12"W

### Standing Height — 35¾" High

<b>BESM370001-0000</b>	1"W
<b>BESM370006-0000</b>	6"W
<b>BESM370012-0000</b>	12"W

## End Scribe Applique Panels

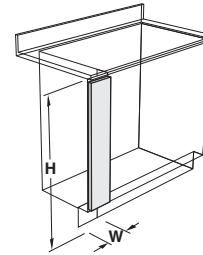

End Applique Panels may be used with End Scribes to match the face of doors and drawer heads on full overlay steel cabinets.

**End Scribe must be ordered separately**

### Sitting Height — 30" High

Steel Square Edge	Steel Radius Edge	Oak Square Edge	Maple Square Edge	
<b>BEAM310006-1100</b>	not available	<b>BEAM310006-1601</b>	<b>BEAM310006-1602</b>	6"W
<b>BEAM310012-1100</b>	<b>BEAM310012-1400</b>	<b>BEAM310012-1601</b>	<b>BEAM310012-1602</b>	12"W

### ADA Height — 33" High — Steel

Steel Square Edge	Steel Radius Edge	Oak Square Edge	Maple Square Edge	
<b>BEAM340006-1100</b>	not available	<b>BEAM340006-1601</b>	<b>BEAM340006-1602</b>	6"W
<b>BEAM340012-1100</b>	<b>BEAM340012-1400</b>	<b>BEAM340012-1601</b>	<b>BEAM340012-1602</b>	12"W

### Standing Height — 35¾" High — Steel

Steel Square Edge	Steel Radius Edge	Oak Square Edge	Maple Square Edge	
<b>BEAM370006-1100</b>	not available	<b>BEAM370006-1601</b>	<b>BEAM370006-1602</b>	6"W
<b>BEAM370012-1100</b>	<b>BEAM370012-1400</b>	<b>BEAM370012-1601</b>	<b>BEAM370012-1602</b>	12"W

## Intermediate Fillers

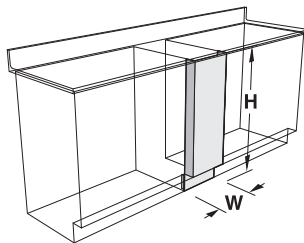

To close opening between two adjacent base cabinets. Includes detached toe space filler.

### Sitting Height — 30" High

<b>BIFM310001-0000</b>	1"W
<b>BIFM310002-0000</b>	2"W
<b>BIFM310004-0000</b>	4"W
<b>BIFM310005-0000</b>	5"W
<b>BIFM310006-0000</b>	6"W
<b>BIFM310018-0000</b>	18"W

### ADA Height — 33" High

<b>BIFM340001-0000</b>	1"W
<b>BIFM340002-0000</b>	2"W
<b>BIFM340004-0000</b>	4"W
<b>BIFM340005-0000</b>	5"W
<b>BIFM340006-0000</b>	6"W
<b>BIFM340018-0000</b>	18"W

### Standing Height — 35¾" High

<b>BIFM370001-0000</b>	1"W
<b>BIFM370002-0000</b>	2"W
<b>BIFM370004-0000</b>	4"W
<b>BIFM370005-0000</b>	5"W
<b>BIFM370006-0000</b>	6"W
<b>BIFM370018-0000</b>	18"W

## Intermediate Applique Panels

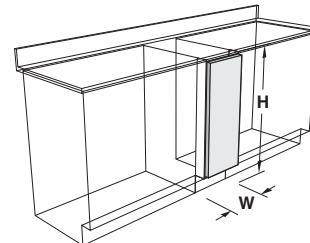

Intermediate Applique Panels may be used with Intermediate Fillers to match the face of doors and drawer heads on full overlay steel cabinets.

**Intermediate Filler must be ordered separately**

### Sitting Height — 30" High

Steel Square Edge	Steel Radius Edge	Oak Square Edge	Maple Square Edge	
<b>BIAM310004-1100</b>	not available	<b>BIAM310004-1601</b>	<b>BIAM310004-1602</b>	4"W
<b>BIAM310005-1100</b>	not available	<b>BIAM310005-1601</b>	<b>BIAM310005-1602</b>	5"W
<b>BIAM310006-1100</b>	not available	<b>BIAM310006-1601</b>	<b>BIAM310006-1602</b>	6"W
<b>BIAM310018-1100</b>	<b>BIAM310018-1400</b>	<b>BIAM310018-1601</b>	<b>BIAM310018-1602</b>	18"W

### ADA Height — 33" High

Steel Square Edge	Steel Radius Edge	Oak Square Edge	Maple Square Edge	
<b>BIAM340004-1100</b>	not available	<b>BIAM340004-1601</b>	<b>BIAM340004-1602</b>	4"W
<b>BIAM340005-1100</b>	not available	<b>BIAM340005-1601</b>	<b>BIAM340005-1602</b>	5"W
<b>BIAM340006-1100</b>	not available	<b>BIAM340006-1601</b>	<b>BIAM340006-1602</b>	6"W
<b>BIAM340018-1100</b>	<b>BIAM340018-1400</b>	<b>BIAM340018-1601</b>	<b>BIAM340018-1602</b>	18"W

### Standing Height — 35¾" High

Steel Square Edge	Steel Radius Edge	Oak Square Edge	Maple Square Edge	
<b>BIAM370004-1100</b>	not available	<b>BIAM370004-1601</b>	<b>BIAM370004-1602</b>	4"W
<b>BIAM370005-1100</b>	not available	<b>BIAM370005-1601</b>	<b>BIAM370005-1602</b>	5"W
<b>BIAM370006-1100</b>	not available	<b>BIAM370006-1601</b>	<b>BIAM370006-1602</b>	6"W
<b>BIAM370018-1100</b>	<b>BIAM370018-1400</b>	<b>BIAM370018-1601</b>	<b>BIAM370018-1602</b>	18"W

# Base Cabinet Scribes & Fillers

## Corner Fillers

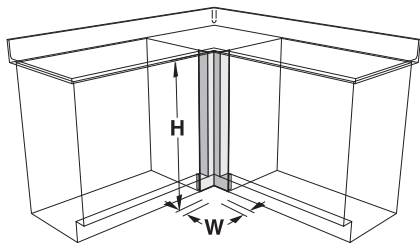

To close opening between two adjacent base cabinets joined at right angles. Includes detached toe space filler.

### Sitting Height — 30" High

<b>BCFM310001-0000</b>	1"W
<b>BCFM310002-0000</b>	2"W
<b>BCFM310003-0000</b>	3"W
<b>BCFM310004-0000</b>	4"W
<b>BCFM310005-0000</b>	5"W
<b>BCFM310006-0000</b>	6"W

### ADA Height — 33" High

<b>BCFM340001-0000</b>	1"W
<b>BCFM340002-0000</b>	2"W
<b>BCFM340003-0000</b>	3"W
<b>BCFM340004-0000</b>	4"W
<b>BCFM340005-0000</b>	5"W
<b>BCFM340006-0000</b>	6"W

### Standing Height — 35¾" High

<b>BCFM370001-0000</b>	1"W
<b>BCFM370002-0000</b>	2"W
<b>BCFM370003-0000</b>	3"W
<b>BCFM370004-0000</b>	4"W
<b>BCFM370005-0000</b>	5"W
<b>BCFM370006-0000</b>	6"W

## Corner Applique Panels

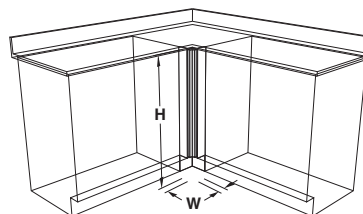

Corner Applique Panels may be used with Corner Fillers to match the face of doors and drawer heads on full overlay steel cabinets.

**Corner Filler must be ordered separately**

### Sitting Height — 30" High

Steel Square Edge	Steel Radius Edge	Oak Square Edge	Maple Square Edge	
<b>BCAM310003-1100</b>	not available	<b>BCAM310003-1601</b>	<b>BCAM310003-1602</b>	3"W
<b>BCAM310006-1100</b>	not available	<b>BCAM310006-1601</b>	<b>BCAM310006-1602</b>	6"W

### ADA Height — 33" High

Steel Square Edge	Steel Radius Edge	Oak Square Edge	Maple Square Edge	
<b>BCAM340003-1100</b>	not available	<b>BCAM340003-1601</b>	<b>BCAM340003-1600</b>	3"W
<b>BCAM340006-1100</b>	not available	<b>BCAM340006-1601</b>	<b>BCAM340006-1602</b>	6"W

### Standing Height — 35¾" High

Steel Square Edge	Steel Radius Edge	Oak Square Edge	Maple Square Edge	
<b>BCAM370003-1100</b>	not available	<b>BCAM370003-1601</b>	<b>BCAM370003-1602</b>	3"W
<b>BCAM370006-1100</b>	not available	<b>BCAM370006-1601</b>	<b>BCAM370006-1602</b>	6"W

## Rear Scribes

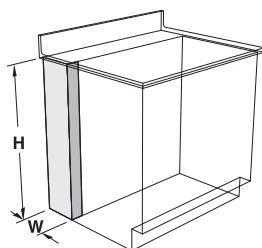

To close opening between wall and rear of adjacent base cabinet. Includes wall mounting angle.

Sitting Height 30" High	ADA Height 33" High	Standing Height 35¾" High	
<b>BRSM310001-0000</b>	<b>BRSM340001-0000</b>	<b>BRSM370001-0000</b>	1"W
<b>BRSM310002-0000</b>	<b>BRSM340002-0000</b>	<b>BRSM370002-0000</b>	2"W
<b>BRSM310004-0000</b>	<b>BRSM340004-0000</b>	<b>BRSM370004-0000</b>	4"W
<b>BRSM310007-0000</b>	<b>BRSM340007-0000</b>	<b>BRSM370007-0000</b>	7"W
<b>BRSM310008-0000</b>	<b>BRSM340008-0000</b>	<b>BRSM370008-0000</b>	8"W
<b>BRSM310010-0000</b>	<b>BRSM340010-0000</b>	<b>BRSM370010-0000</b>	10"W

## Pipe Chase Fillers

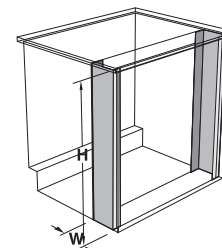
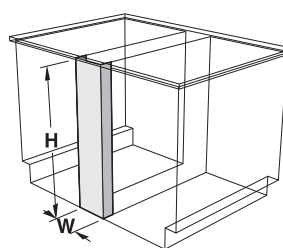

To close opening between two adjacent base cabinets installed back-to-back. May also be used with a finished back to create a pipe chase behind a free standing cabinet to create a single-sided island or peninsula.

Sitting Height 30" High	ADA Height 33" High	Standing Height 35¾" High	
<b>BPCM310002-0000</b>	<b>BPCM340002-0000</b>	<b>BPCM370002-0000</b>	2"W
<b>BPCM310007-0000</b>	<b>BPCM340007-0000</b>	<b>BPCM370007-0000</b>	7"W
<b>BPCM310008-0000</b>	<b>BPCM340008-0000</b>	<b>BPCM370008-0000</b>	8"W
<b>BPCM310014-0000</b>	<b>BPCM340014-0000</b>	<b>BPCM370014-0000</b>	14"W
<b>BPCM310016-0000</b>	<b>BPCM340016-0000</b>	<b>BPCM370016-0000</b>	16"W
<b>BPCM310020-0000</b>	<b>BPCM340020-0000</b>	<b>BPCM370020-0000</b>	20"W

# Wall Cabinet Scribes & Fillers

## End Scribes

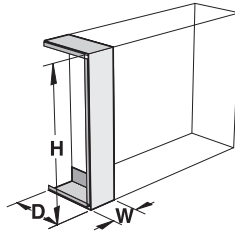

To close opening between wall and front of adjacent wall cabinet. Includes wall mounting angles.

### 24" High

12<sup>3</sup>/<sub>4</sub>" Deep

16" Deep

<b>WESM241301-0000</b>	<b>WESM241601-0000</b>	1"W
<b>WESM241306-0000</b>	<b>WESM241606-0000</b>	6"W
<b>WESM241312-0000</b>	<b>WESM241612-0000</b>	12"W

### 30" High

12<sup>3</sup>/<sub>4</sub>" Deep

16" Deep

<b>WESM301301-0000</b>	<b>WESM301601-0000</b>	1"W
<b>WESM301306-0000</b>	<b>WESM301606-0000</b>	6"W
<b>WESM301312-0000</b>	<b>WESM301612-0000</b>	12"W

### 36" High

12<sup>3</sup>/<sub>4</sub>" Deep

16" Deep

<b>WESM361301-0000</b>	<b>WESM361601-0000</b>	1"W
<b>WESM361306-0000</b>	<b>WESM361606-0000</b>	6"W
<b>WESM361312-0000</b>	<b>WESM361612-0000</b>	12"W

### 47" High

12<sup>3</sup>/<sub>4</sub>" Deep

16" Deep

<b>WESM471301-0000</b>	<b>WESM471601-0000</b>	1"W
<b>WESM471306-0000</b>	<b>WESM471606-0000</b>	6"W
<b>WESM471312-0000</b>	<b>WESM471612-0000</b>	12"W

## End Scribe Applique Panel

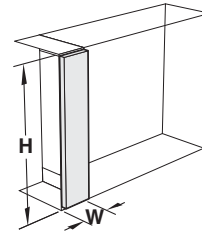

End Applique Panels may be used with End Scribes to match the face of doors and drawer heads on full overlay steel cabinets.

**End Scribe must be ordered separately**

### 24" High

Steel Square Edge

Steel Radius Edge

<b>WEAM240006-1100</b>	not available	6"W
<b>WEAM240012-1100</b>	<b>WEAM240012-1400</b>	12"W

### 24" High

Oak

Maple

<b>WEAM240006-1601</b>	<b>WEAM240006-1602</b>	6"W
<b>WEAM240012-1601</b>	<b>WEAM240012-1602</b>	12"W

### 30" High

Steel Square Edge

Steel Radius Edge

<b>WEAM300006-1100</b>	not available	6"W
<b>WEAM300012-1100</b>	<b>WEAM300012-1400</b>	12"W

### 30" High

Oak

Maple

<b>WEAM300006-1601</b>	<b>WEAM300006-1602</b>	6"W
<b>WEAM300012-1601</b>	<b>WEAM300012-1602</b>	12"W

### 36" High

Steel Square Edge

Steel Radius Edge

<b>WEAM360006-1100</b>	not available	6"W
<b>WEAM360012-1100</b>	<b>WEAM360012-1400</b>	12"W

### 36" High

Oak

Maple

<b>WEAM360006-1601</b>	<b>WEAM360006-1602</b>	6"W
<b>WEAM360012-1601</b>	<b>WEAM360012-1602</b>	12"W

### 47" High

Steel Square Edge

Steel Radius Edge

<b>WEAM470006-1100</b>	not available	6"W
<b>WEAM470012-1100</b>	<b>WEAM470012-1400</b>	12"W

### 47" High

Oak

Maple

<b>WEAM470006-1601</b>	<b>WEAM470006-1602</b>	6"W
<b>WEAM470012-1601</b>	<b>WEAM470012-1602</b>	12"W

# Wall Cabinet Scribes & Fillers

## Intermediate Fillers

## Intermediate Filler Applique Panel

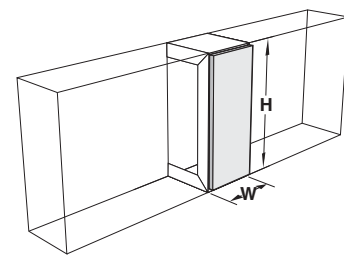
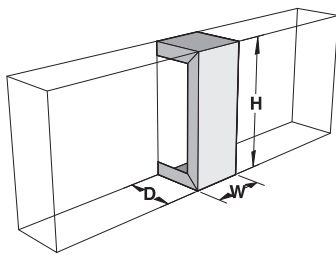

To close opening between two adjacent wall cabinets.

Intermediate Applique Panels may be used with Intermediate Fillers to match the face of doors and drawer heads on full overlay steel cabinets.

**Intermediate Filler must be ordered separately**

24" High		
12 <sup>3</sup> / <sub>4</sub> " Deep	16" Deep	
WIFM241301-0000	WIFM241601-0000	1"W
WIFM241304-0000	WIFM241604-0000	4"W
WIFM241305-0000	WIFM241605-0000	5"W
WIFM241306-0000	WIFM241606-0000	6"W
WIFM241318-0000	WIFM241618-0000	18"W
WIFM241324-0000	WIFM241624-0000	24"W

30" High		
12 <sup>3</sup> / <sub>4</sub> " Deep	16" Deep	
WIFM301301-0000	WIFM301601-0000	1"W
WIFM301304-0000	WIFM301604-0000	4"W
WIFM301305-0000	WIFM301605-0000	5"W
WIFM301306-0000	WIFM301606-0000	6"W
WIFM301318-0000	WIFM301618-0000	18"W
WIFM301324-0000	WIFM301624-0000	24"W

36" High		
12 <sup>3</sup> / <sub>4</sub> " Deep	16" Deep	
WIFM361301-0000	WIFM361601-0000	1"W
WIFM361304-0000	WIFM361604-0000	4"W
WIFM361305-0000	WIFM361605-0000	5"W
WIFM361306-0000	WIFM361606-0000	6"W
WIFM361318-0000	WIFM361618-0000	18"W
WIFM361324-0000	WIFM361624-0000	24"W

47" High		
12 <sup>3</sup> / <sub>4</sub> " Deep	16" Deep	
WIFM471301-0000	WIFM471601-0000	1"W
WIFM471304-0000	WIFM471604-0000	4"W
WIFM471305-0000	WIFM471605-0000	5"W
WIFM471306-0000	WIFM471606-0000	6"W
WIFM471318-0000	WIFM471618-0000	18"W
WIFM471324-0000	WIFM471624-0000	24"W

24" High		
Steel Square Edge	Steel Radius Edge	
WIAM240006-1100	not available	6"W
WIAM240018-1100	WIAM240018-1400	18"W
WIAM240024-1100	WIAM240024-1400	24"W

24" High		
Oak	Maple	
WIAM240006-1601	WIAM240006-1602	6"W
WIAM240018-1601	WIAM240018-1602	18"W
WIAM240024-1601	WIAM240024-1602	24"W

30" High — Steel		
Steel Square Edge	Steel Radius Edge	
WIAM300006-1100	not available	6"W
WIAM300018-1100	WIAM300018-1400	18"W
WIAM300024-1100	WIAM300024-1400	24"W

30" High — Steel		
Oak	Maple	
WIAM300006-1601	WIAM300006-1602	6"W
WIAM300018-1601	WIAM300018-1602	18"W
WIAM300024-1601	WIAM300024-1602	24"W

36" High		
Steel Square Edge	Steel Radius Edge	
WIAM360006-1100	not available	6"W
WIAM360018-1100	WIAM360018-1400	18"W
WIAM360024-1100	WIAM360024-1400	24"W

36" High		
Oak	Maple	
WIAM360006-1601	WIAM360006-1602	6"W
WIAM360018-1601	WIAM360018-1602	18"W
WIAM360024-1601	WIAM360024-1602	24"W

47" High		
Steel Square Edge	Steel Radius Edge	
WIAM470006-1100	not available	6"W
WIAM470018-1100	WIAM470018-1400	18"W
WIAM470024-1100	WIAM470024-1400	24"W

47" High		
Oak	Maple	
WIAM470006-1601	WIAM470006-1602	6"W
WIAM470018-1601	WIAM470018-1602	18"W
WIAM470024-1601	WIAM470024-1602	24"W

# Wall Cabinet Fillers & Scribes

## Corner Fillers

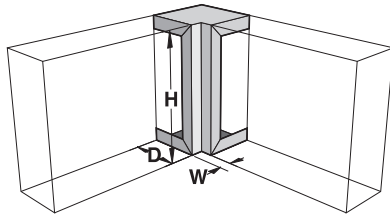

To close opening between two adjacent wall cabinets joined at right angles.

### 24" High

12<sup>3</sup>/<sub>4</sub>" Deep

16" Deep

WCFM241301-0000	WCFM241601-0000	1"W
WCFM241302-0000	WCFM241602-0000	2"W
WCFM241303-0000	WCFM241603-0000	3"W
WCFM241304-0000	WCFM241604-0000	4"W
WCFM241365-0000	WCFM241605-0000	5"W
WCFM241306-0000	WCFM241606-0000	6"W

### 30" High

12<sup>3</sup>/<sub>4</sub>" Deep

16" Deep

WCFM301301-0000	WCFM301601-0000	1"W
WCFM301302-0000	WCFM301602-0000	2"W
WCFM301303-0000	WCFM301603-0000	3"W
WCFM301304-0000	WCFM301604-0000	4"W
WCFM301305-0000	WCFM301605-0000	5"W
WCFM301306-0000	WCFM301606-0000	6"W

### 36" High

12<sup>3</sup>/<sub>4</sub>" Deep

16" Deep

WCFM361301-0000	WCFM361601-0000	1"W
WCFM361302-0000	WCFM361602-0000	2"W
WCFM361303-0000	WCFM361603-0000	3"W
WCFM361304-0000	WCFM361604-0000	4"W
WCFM361305-0000	WCFM361605-0000	5"W
WCFM361306-0000	WCFM361605-0000	6"W

### 47" High

12<sup>3</sup>/<sub>4</sub>" Deep

16" Deep

WCFM471301-0000	WCFM471601-0000	1"W
WCFM471302-0000	WCFM471602-0000	2"W
WCFM471303-0000	WCFM471603-0000	3"W
WCFM471304-0000	WCFM471604-0000	4"W
WCFM471305-0000	WCFM471605-0000	5"W
WCFM471306-0000	WCFM471606-0000	6"W

## Corner Fillers Applique Panel

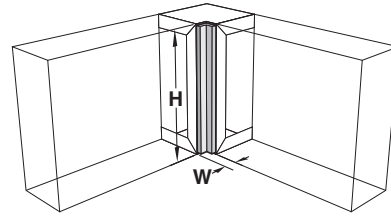

Corner Applique Panels may be used with Corner Fillers to match the face of doors and drawer heads on full overlay steel cabinets.

**Corner Filler must be ordered separately**

### 24" High

Steel Square Edge

Steel Radius Edge

WCAM240003-1100	not available	3"W
WCAM240006-1100	not available	6"W

### 24" High

Oak

Maple

WCAM240003-1601	WCAM240003-1602	2"W
WCAM240006-1601	WCAM240006-1602	6"W

### 30" High

Steel Square Edge

Steel Radius Edge

WCAM300003-1100	not available	3"W
WCAM300006-1100	not available	6"W

### 30" High

Oak

Maple

WCAM300003-1601	WCAM300003-1602	3"W
WCAM300006-1601	WCAM300006-1602	6"W

### 36" High

Steel Square Edge

Steel Radius Edge

WCAM360003-1100	not available	3"W
WCAM360006-1100	not available	6"W

### 36" High

Oak

Maple

WCAM360003-1601	WCAM360003-1602	3"W
WCAM360006-1601	WCAM360006-1602	6"W

### 47" High

Steel Square Edge

Steel Radius Edge

WIAM470003-1100	not available	3"W
WIAM470006-1100	not available	6"W

### 47" High

Oak

Maple

WCAM470003-1601	WCAM470003-1602	3"W
WCAM470006-1601	WCAM470006-1602	6"W

# Full Height Cabinet Fillers & Scribes

## Full Height End Scribes

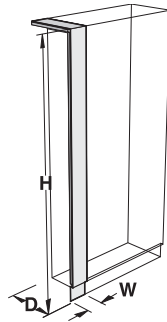

To close opening between wall and front of adjacent full height cabinets. Includes detached toe space scribe and wall mounting angles.

12<sup>3</sup>/<sub>4</sub>" Deep

<b>FESM841301-0000</b>	1"W
<b>FESM841306-0000</b>	6"W
<b>FESM841312-0000</b>	12"W

16" Deep

<b>FESM841601-0000</b>	1"W
<b>FESM841606-0000</b>	6"W
<b>FESM841612-0000</b>	12"W

22" Deep

<b>FESM842201-0000</b>	1"W
<b>FESM842206-0000</b>	6"W
<b>FESM842212-0000</b>	12"W

## Full Height End Applique Panel

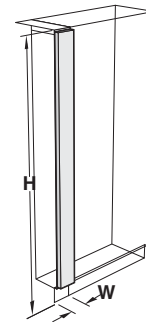

End Applique Panels may be used with End Scribes to match the face of doors and drawer heads on full overlay steel cabinets.

**End Scribe must be ordered separately**

Steel Square Edge	Steel Radius Edge	
<b>FEAM840006-1100</b>	not available	6"W
<b>FEAM840012-1100</b>	<b>FEAM840012-1400</b>	12"W
Oak	Maple	
<b>FEAM840006-1601</b>	<b>FEAM840006-1602</b>	6"W
<b>FEAM840012-1601</b>	<b>FEAM840012-1602</b>	12"W

## Full Height Intermediate Fillers

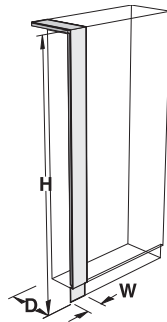

To close opening between two adjacent full height cabinets. Includes detached toe space filler.

12<sup>3</sup>/<sub>4</sub>" Deep

<b>FIFM841301-0000</b>	1"W
<b>FIFM841306-0000</b>	6"W
<b>FIFM841312-0000</b>	12"W

16" Deep

<b>FIFM841601-0000</b>	1"W
<b>FIFM841606-0000</b>	6"W
<b>FIFM841612-0000</b>	12"W

22" Deep

<b>FIFM842201-0000</b>	1"W
<b>FIFM842206-0000</b>	6"W
<b>FIFM842212-0000</b>	12"W

## Full Height Intermediate Applique Panel

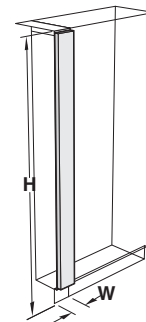

Intermediate Applique Panels may be used with Intermediate Fillers to match the face of doors and drawer heads on full overlay steel cabinets.

**Intermediate Fillers must be ordered separately**

Steel Square Edge	Steel Radius Edge	
<b>FIAM840006-1100</b>	not available	6"W
<b>FIAM840012-1100</b>	<b>FIAM840012-1400</b>	12"W
Oak	Maple	
<b>FIAM840006-1601</b>	<b>FIAM840006-1602</b>	6"W
<b>FIAM840012-1601</b>	<b>FIAM840012-1602</b>	12"W

# Full Height Cabinet Fillers, Scribes & Panels

## Corner Filler

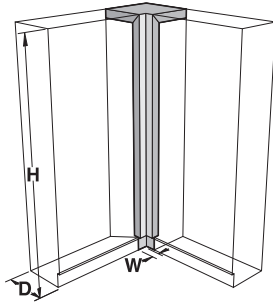

To close opening between two adjacent full height cabinets joined at right angles. Includes detached toe space filler.

12<sup>3</sup>/<sub>4</sub>" Deep

<b>FCFM841301-0000</b>	1"W
<b>FCFM841303-0000</b>	3"W
<b>FCFM841306-0000</b>	6"W

16" Deep

<b>FCFM841601-0000</b>	1"W
<b>FCFM841603-0000</b>	3"W
<b>FCFM841606-0000</b>	6"W

22" Deep

<b>FCFM842201-0000</b>	1"W
<b>FCFM842203-0000</b>	3"W
<b>FCFM842206-0000</b>	6"W

## Corner Fillers Applique Panel

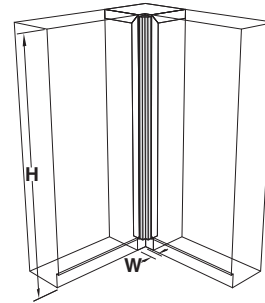

Corner Applique Panels may be used with Corner Fillers to match the face of doors and drawer heads on full overlay steel cabinets.

**Corner Filler must be ordered separately**

Steel Square Edge	Steel Radius Edge	
<b>FCAM840003-1100</b>	not available	3"W
<b>FCAM840006-1100</b>	not available	6"W
Oak	Maple	
<b>FCAM840003-1601</b>	<b>FCAM840003-1602</b>	3"W
<b>FCAM840006-1601</b>	<b>FCAM840006-1602</b>	6"W

## Full Height Rear Scribe

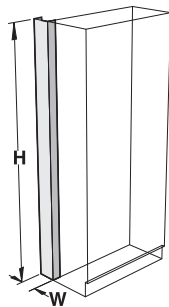

To close opening between wall and rear of adjacent full height cabinets.

56" High

<b>FRSM560001-0000</b>	<b>FRSM840001-0000</b>	1"W
<b>FRSM560004-0000</b>	<b>FRSM840004-0000</b>	4"W
<b>FRSM560007-0000</b>	<b>FRSM840007-0000</b>	7"W
<b>FRSM560008-0000</b>	<b>FRSM840008-0000</b>	8"W

84" High

## Full Height Finished Back

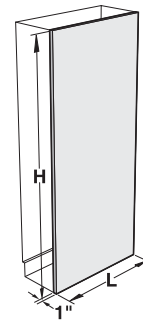

To cover backs of full height cabinets exposed to view. Adds 1" to depth of cabinet.

84" High

<b>FFBM840118-0000</b>	18"W
<b>FFBM840124-0000</b>	24"W
<b>FFBM840130-0000</b>	30"W
<b>FFBM840136-0000</b>	36"W
<b>FFBM840142-0000</b>	42"W
<b>FFBM840148-0000</b>	48"W

# Steel Cabinet Finished Backs

## Base Cabinet Finished Back

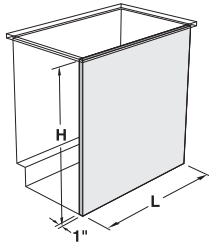

To cover backs of base cabinets exposed to view. Back adds 1" to the depth of the base cabinet.

### Sitting Height — 30" High

<b>BFBM310112-0000</b>	12"W
<b>BFBM310115-0000</b>	18"W
<b>BFBM310118-0000</b>	18"W
<b>BFBM310121-0000</b>	21"W
<b>BFBM310124-0000</b>	24"W
<b>BFBM310130-0000</b>	30"W
<b>BFBM310136-0000</b>	36"W
<b>BFBM310142-0000</b>	42"W
<b>BFBM310148-0000</b>	48"W
<b>BFBM310160-0000</b>	60"W

### ADA Height — 33" High

<b>BFBM340112-0000</b>	12"W
<b>BFBM340115-0000</b>	15"W
<b>BFBM340118-0000</b>	18"W
<b>BFBM340121-0000</b>	21"W
<b>BFBM340124-0000</b>	24"W
<b>BFBM340130-0000</b>	30"W
<b>BFBM340136-0000</b>	36"W
<b>BFBM340142-0000</b>	42"W
<b>BFBM340148-0000</b>	48"W
<b>BFBM340160-0000</b>	60"W

### Standing Height — 35¾" High

<b>BFBM370112-0000</b>	12"W
<b>BFBM370115-0000</b>	15"W
<b>BFBM370118-0000</b>	18"W
<b>BFBM370121-0000</b>	21"W
<b>BFBM370124-0000</b>	24"W
<b>BFBM370130-0000</b>	30"W
<b>BFBM370136-0000</b>	36"W
<b>BFBM370142-0000</b>	42"W
<b>BFBM370148-0000</b>	48"W
<b>BFBM370160-0000</b>	60"W

## Wall Cabinet Finished Back

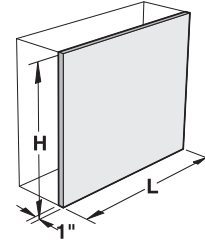

To cover backs of wall cabinets exposed to view. Adds 1" to depth of cabinet.

### 24" High

<b>WFBM240115-0000</b>	15"W
<b>WFBM240118-0000</b>	18"W
<b>WFBM240121-0000</b>	21"W
<b>WFBM240124-0000</b>	24"W
<b>WFBM240130-0000</b>	30"W
<b>WFBM240136-0000</b>	36"W
<b>WFBM240142-0000</b>	42"W
<b>WFBM240148-0000</b>	48"W

### 30" High

<b>WFBM300115-0000</b>	15"W
<b>WFBM300118-0000</b>	18"W
<b>WFBM300121-0000</b>	21"W
<b>WFBM300124-0000</b>	24"W
<b>WFBM300130-0000</b>	30"W
<b>WFBM300136-0000</b>	36"W
<b>WFBM300142-0000</b>	42"W
<b>WFBM300148-0000</b>	48"W

### 36" High

<b>WFBM360115-0000</b>	15"W
<b>WFBM360118-0000</b>	18"W
<b>WFBM360121-0000</b>	21"W
<b>WFBM360124-0000</b>	24"W
<b>WFBM360130-0000</b>	30"W
<b>WFBM360136-0000</b>	36"W
<b>WFBM360142-0000</b>	42"W
<b>WFBM360148-0000</b>	48"W

### 47" High

<b>WFBM470115-0000</b>	15"W
<b>WFBM470118-0000</b>	18"W
<b>WFBM470121-0000</b>	21"W
<b>WFBM470124-0000</b>	24"W
<b>WFBM470130-0000</b>	30"W
<b>WFBM470136-0000</b>	36"W
<b>WFBM470142-0000</b>	42"W
<b>WFBM470148-0000</b>	48"W

# Steel Sloping Tops & Ceiling Enclosures

## Sloping Tops

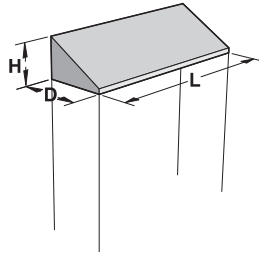

May be used on wall cabinets and full height cabinets to keep the tops dust free.

8 <sup>3</sup> / <sub>8</sub> " High 12 <sup>3</sup> / <sub>4</sub> " Deep	10 <sup>3</sup> / <sub>4</sub> " High 16" Deep	13 <sup>3</sup> / <sub>4</sub> " High 22" Deep	
SLTM081315-0000	SLTM111615-0000	SLTM142215-0000	15"L
SLTM081318-0000	SLTM111618-0000	SLTM142218-0000	18"L
SLTM081321-0000	SLTM111621-0000	SLTM142221-0000	21"L
SLTM081324-0000	SLTM111624-0000	SLTM142224-0000	24"L
SLTM081330-0000	SLTM111630-0000	SLTM142230-0000	30"L
SLTM081336-0000	SLTM111636-0000	SLTM142236-0000	36"L
SLTM081342-0000	SLTM111642-0000	SLTM142242-0000	42"L
SLTM081348-0000	SLTM111648-0000	SLTM142248-0000	48"L
SLTM081360-0000	SLTM111660-0000	SLTM142260-0000	60"L
SLTM081372-0000	SLTM111672-0000	SLTM142272-0000	72"L
SLTM081384-0000	SLTM111684-0000	SLTM142284-0000	84"L
SLTM081396-0000	SLTM111696-0000	SLTM142296-0000	96"L

## Sloping Top Fillers

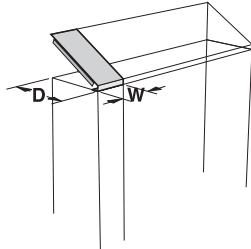

To close opening between wall and front of adjacent sloping top. Includes wall mounting angle.

8 <sup>3</sup> / <sub>8</sub> " High 12 <sup>3</sup> / <sub>4</sub> " Deep	10 <sup>3</sup> / <sub>4</sub> " High 16" Deep	13 <sup>3</sup> / <sub>4</sub> " High 22" Deep	
STFM081301-0000	STFM111601-0000	STFM142201-0000	1"W
STFM081306-0000	STFM111606-0000	STFM142206-0000	6"W
STFM081312-0000	STFM111612-0000	STFM142212-0000	12"W

## Sloping Top Corner Fillers

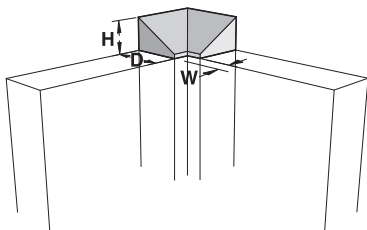

May be used on wall cabinets and full height cabinets when cabinets are joined at right angles.

8 <sup>3</sup> / <sub>8</sub> " High 12 <sup>3</sup> / <sub>4</sub> " Deep	10 <sup>3</sup> / <sub>4</sub> " High 16" Deep	13 <sup>3</sup> / <sub>4</sub> " High 22" Deep	
SCFM081301-0000	SCFM111601-0000	SCFM142201-0000	1"W
SCFM081306-0000	SCFM111606-0000	SCFM142206-0000	6"W

## Ceiling Enclosures

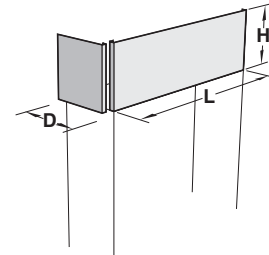

To close opening between ceiling and top of wall or full height cabinets.

### Front Ceiling Enclosure

12" High	24" High	
FCEM120018-0000	FCEM240018-0000	18"L
FCEM120024-0000	FCEM240024-0000	24"L
FCEM120030-0000	FCEM240030-0000	30"L
FCEM120036-0000	FCEM240036-0000	36"L
FCEM120042-0000	FCEM240042-0000	42"L
FCEM120048-0000	FCEM240048-0000	48"L
FCEM120060-0000	FCEM240060-0000	60"L
FCEM120072-0000	FCEM240072-0000	72"L
FCEM120084-0000	FCEM240084-0000	84"L
FCEM120096-0000	FCEM240096-0000	96"L

### End Ceiling Enclosure

12" High	24" High	
ECEM120013-0000	ECEM240013-0000	12 <sup>3</sup> / <sub>4</sub> "D
ECEM120016-0000	ECEM240016-0000	16"D
ECEM120022-0000	ECEM240022-0000	22"D

## Corner Ceiling Enclosures

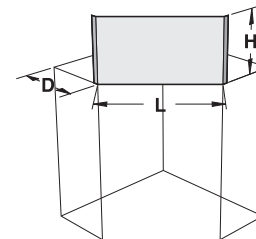

To close opening between ceiling and top of corner wall cabinets.

12" High	24" High	Depth	Length
CCEM121320-0000	CCEM241320-0000	12 <sup>3</sup> / <sub>4</sub> "	20"
CCEM121615-0000	CCEM241615-0000	16"	15 <sup>3</sup> / <sub>8</sub> "

## Corner Cabinet Sloping Tops

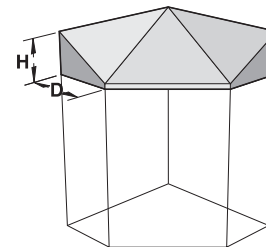

To be used on corner wall cabinets.

8 <sup>3</sup> / <sub>8</sub> " High 12 <sup>3</sup> / <sub>4</sub> " Deep	10 <sup>3</sup> / <sub>4</sub> " High 16" Deep	
CSTM081327-0000	CSTM111627-0000	26 <sup>7</sup> / <sub>8</sub> "L

# Steel Adjustable Slip Scribes

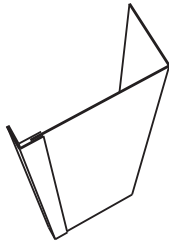

## Specifications:

Steel Adjustable Slip Scribes are designed the same as standard scribes with the addition of a Slip-on Angle at the wall edge to dress-up the edge of the scribe.

The Steel Adjustable Slip Scribe is designed to be cut to width in the field to more easily fit the space between the wall and the end of the furniture assembly.

### Base Cabinet Adjustable End Scribe

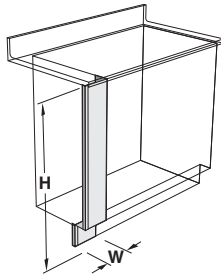

To close opening between wall and front of adjacent base cabinets. Includes detached toe space scribe and wall scribing angles.

#### Sitting Height — 30" High

**ABSM310012-0000** 12"W

#### ADA Height — 33" High

**ABSM340012-0000** 12"W

#### Standing Height — 35¾" High

**ABSM370012-0000** 12"W

### Wall Cabinet Adjustable End Scribes

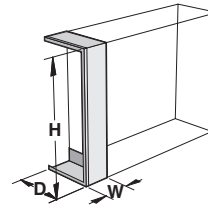

To close opening between wall and front of adjacent wall cabinet. Includes wall scribing angle.

12¾" Deep

16" Deep

#### 24" High

**AWSM241312-0000** 12"W      **AWSM241612-0000** 12"W

#### 30" High

**AWSM301312-0000** 12"W      **AWSM301612-0000** 12"W

#### 36" High

**AWSM361312-0000** 12"W      **AWSM361612-0000** 12"W

#### 47" High

**AWSM471312-0000** 12"W      **AWSM471612-0000** 12"W

### Full Height Cabinet Adjustable End Scribes

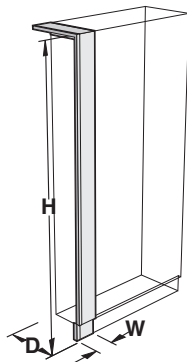

To close opening between wall and front of adjacent full height cabinets. Includes detached toe space scribe and wall scribing angles.

12¾" Deep

**AFSM841312-0000** 12"W

16" Deep

**AFSM841612-0000** 12"W

22" Deep

**AFSM842212-0000** 12"W