

# Wood Cabinet Options

## Casters Added to Base Cabinets

### Option B

Option B converts a fixed base cabinet into a mobile unit. It removes the toe space from the bottom of the cabinet and adds swivel casters and a finished back. Casters are available with either 3" or 4" diameter black

rubber tires, and with or without wheel brakes.

3" diameter casters add no extra height to the cabinet, 4" diameter casters add 1 1/4" to the overall height.

**B1** – 4" Casters with brakes

**B2** – 4" Casters without brakes

**B3** – 4" Casters with brakes at front only.

**B4** – 3" Casters with brakes

**B5** – 3" Casters without brakes

**B6** – 3" Casters with brakes at front only

To specify Casters, add **B\_** to the end of the cabinet number.

Example: **E40W362236-1011B6**  
(Available on base cabinets only.)

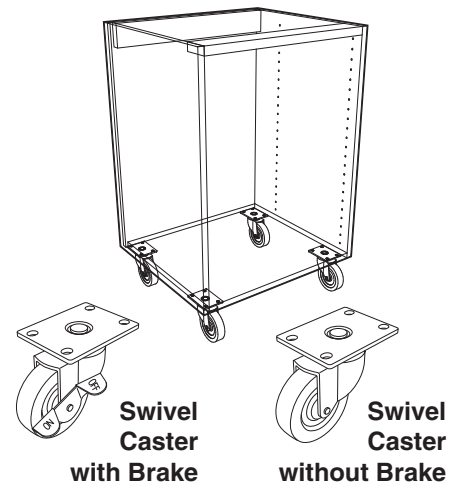

## 1" Added to Base Cabinet Height

### Option C

Option C adds a 1" high cleat to the bottom of the end panels and the toespace rail on base cabinets. This allows the wood base cabinet to

match the height of a steel base cabinet when the two are installed adjacent to each other.

To specify increased height, add **C** to the end of the cabinet number.

Example: **E40W362236-1011C**  
(Available on base cabinets only.)

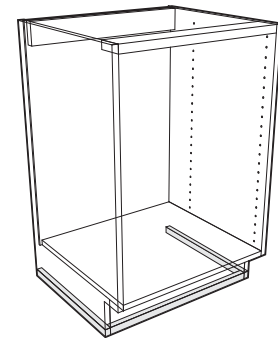

## Full Top Frame

### Option D

Option D adds two side rails to the base cabinet's front and back rails to form a full, four-sided frame at the top of the cabinet.

**Note:** D option not available on base cabinets with pullboards.

To specify a cabinet with Full Top Frame, add **D** to the end of the cabinet number.

Example: **E40W362236-1011D**  
(Available on base cabinets only.)

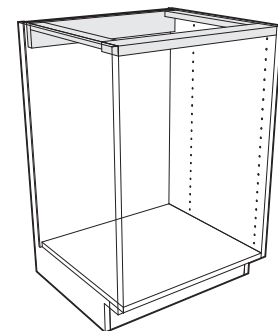

## Finished Back

### Option E

When a cabinet will be installed away from a wall so that its back is exposed to view, the cabinet can be constructed with a hardwood plywood back flush with the end

panels instead of the standard recessed hardboard back. Finished backs may be specified for base cabinets, full height cabinets or wall cabinets.

**Note:** Finished backs are standard when Option B is specified.

To specify Finished Back, add **E** to the end of the cabinet number.

Example: **E40W362236-1011E**

# Wood Cabinet Options

## Removable Back

### Option F

Removable backs allow easy access to plumbing spaces behind base cabinets. When a removable back is specified, a 16" high access opening is cut in the cupboard back and

covered with a nominal 1/4"-(5.5mm) hardboard back held in place by four screws. A removable back may be added to any base cabinet with a cupboard at least 17 1/2" high.

To specify Removable Back, add **F** to the end of the cabinet number.

Example: **E40W362236-1011F**  
(Available in base cabinet cupboards only.)

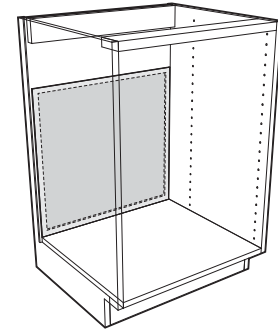

## Toospace Grill

### Option G

Toospace Grills are available when a base cabinet or full height cabinet must be installed in front of, or on top of, heating registers or ducts. A two

inch high opening is cut in the cabinet toospace rail and is fitted with a black expanded steel grill.

To specify Toospace Grill, add **G** to the end of the cabinet number.

Example: **E40W362236-1011G**

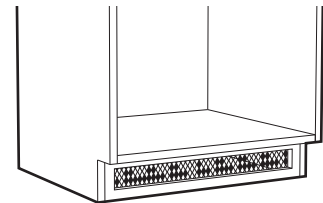

## Cabinet Levelers

### Option M

Base cabinets and full height cabinets can be furnished with adjustable levelers when required. Each cabinet is furnished with four (4)

levelers. The levelers are accessible for adjustment through holes in the cabinet bottom that are covered with plug buttons.

To specify Cabinet Leveler, add **M** to the end of the cabinet number.

Example: **E40W362236-1011M**  
(Available on base cabinets and full height cabinets only.)

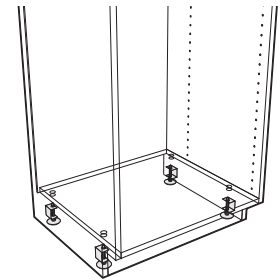

## White Drawer Bottoms

### Option W

Standard hardboard drawer bottoms may be replaced with a white hardboard bottom for increased visibility and ease of cleaning.

White Drawer Bottoms are nominal 1/4"-(5.5mm) thick hardboard with white melamine coating.

To specify White Drawer Bottoms, add **W** to the end of the cabinet number.

Example: **E40W362236-1011W**  
(Will be added to all drawers in the cabinet)

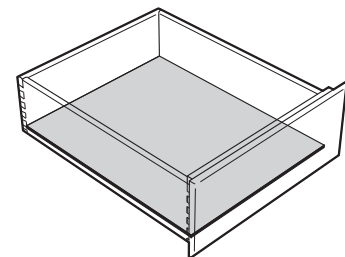

## Intermediate Rails on Style 5

### Option Y

Style 5 Contemporary Full Overlay base cabinets are furnished standard without intermediate rails between drawers or between cupboards and drawers. They may be added to the cabinet by specifying them with Option Y.

**Note:** Intermediate Rails are automatically added to Style 5 base cabinets when any lock option is selected.

**Note:** Option Y not required for Styles 1 and 3 as they are furnished standard with Intermediate Rails.

To specify Intermediate Rails, add **Y** to the end of the cabinet number.

Example: **E40W362236-5016Y**  
(Available for Style 5 - Contemporary Full Overlay base cabinets only.)

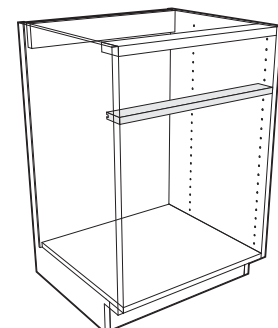

# Wood Cabinet Options

## Shelf Lips

## Option O

Adds a 1/2" thick solid hardwood lip to the front of all shelves in the cabinet to form a 1/2" high retaining rim. Shelf lips may be added to Base Cabinets, Wall or Counter Mounted

Storage Cabinets or Full Height Storage Cabinets. The overall depth of the shelf remains the same.

To specify Shelf Lips, add **O** to the end of the cabinet number.

Example: **E40W362236-1011O**  
(Added to all shelves in cabinet.)

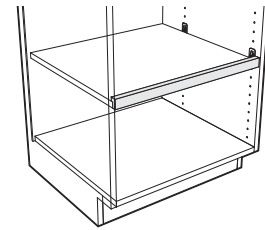

## Pullout Trays & Pullout Pans

## Option P

**P1** – One Pullout Tray - at bottom of cupboard  
**P2** – Two Pullout Trays - center & bottom

Pullout trays are fabricated from 1/2" thick birch plywood with 1" high rims on both sides and back. They are mounted on 100 pound capacity lineal ball bearing full-extension slides. Available in two configurations: one tray, mounted at bottom of

cupboard; or two trays, mounted at bottom and in center of cupboard. When pullout trays are added, the adjustable shelf is omitted.

Pullout trays are available for base cabinets only.

To specify a Pullout Tray, add **P1** or **P2** to the end of the cabinet number.

Example: **E40W362236-1011P2**  
(Available for base cabinets only.)

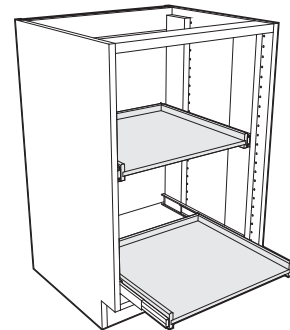

**P5** – One Pullout Pan - at bottom of cupboard  
**P6** – Two Pullout Pans - center & bottom

Pullout Pans are fabricated from 1/2" thick birch plywood with 1" high rims on both sides and back, and 3/4" solid hardwood front. They are mounted on 100 pound capacity lineal ball bearing full-extension slides. Available in two configurations: one tray, mounted

at bottom of cupboard; or two trays, mounted at bottom and in center of cupboard. When pullout trays are added, the adjustable shelf is omitted.

Pullout trays are available for base cabinets only.

To specify a Pullout Pan, add **P5** or **P6** to the end of the cabinet number.

Example: **E40W362236-1011P6**  
(Available for base cabinets only.)

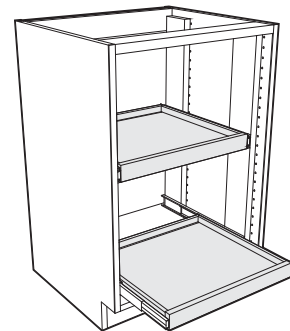

## Tempered Safety Glass

## Option R

Replaces the standard 1/8" float glass in glazed door wall, counter

mounted and full height cabinets with 1/8" Tempered SafetyGlass

To specify Tempered Glass, add **R** to the end of the cabinet number.

Example: **W20W361236-1011R**

## Full Extension Slides

## Option T

Full extension ball bearing drawer slide with cushioned in and outstops and positive drawer hold-in detent. Loading capacity of 100 pounds. Replaces standard single extension

slides on all drawers in cabinet when T option is specified.

To specify Full Extension Slide, add **T** to the end of the cabinet number.

Example: **E40W362236-1011T**  
(Added to all drawers in cabinet except file drawers.)

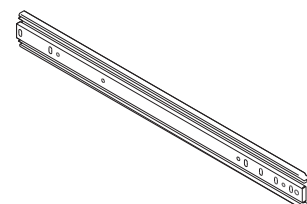

# Wood Cabinet Options

## Label Holders

## Option H

The H Option adds the F-0260-00 aluminum Label Holder to the upper right hand corner of each drawer head and to the center, 4" down on each door on the cabinet. Overall

size is 3" x 1<sup>5</sup>/<sub>8</sub>" and holds a 2<sup>1</sup>/<sub>2</sub>" x 1<sup>1</sup>/<sub>8</sub>" card. (Label holder is placed on right hand door only of double door cupboards.)

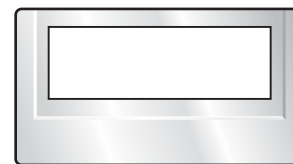

One-half Actual Size

To specify Label Holders, add **H** to the end of the cabinet number.

Example: **E40W362236-1011H**  
(Added to all cupboards and drawers.)

## Locks with Lock Panels Locks without Lock Panels

## Option J Option K

All cabinets may be ordered with locks by specifying the K option. In addition, base cabinets may be specified with the J option to add lock panels. Lock panels are

installed between drawers and/or drawers and cupboards to provide additional security when the locks on a cabinet are keyed different.

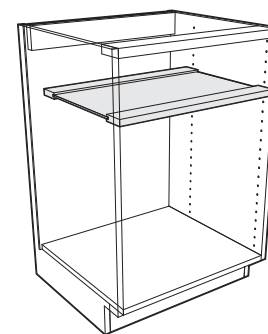

Lock Panel

### Locks Types

Cabinet locks are available in two types. Disk Tumbler which offers medium security, and Pin Tumbler which offer a higher level of security. Pin Tumbler also allows more keying arrangements. Both are fabricated with die cast sleeves and cylinders

with a satin nickel face and zinc plated steel cams. Both locks use the same sleeve and cam assembly allowing the lock cylinder to be removed and switched after the lock has been installed. All locks are furnished with two keys unless otherwise specified.

### Disk Tumbler Locks

**Security:** Medium  
**Keying:** Different, Alike, Alike in Sets, Masterkeyed

**Key Changes:** Up to 2000  
**Master Key Changes:** Up to 10

### Pin Tumbler Locks

**Security:** Medium-High  
**Keying:** Different, Alike, Alike in Sets, Masterkeyed, Grand-masterkeyed, Sub-masterkeyed, Mason Keyed

**Key Changes:** Up to 2000  
**Master Key Changes:** Up to 52

**J** – Disk Locks with Lock Panels  
**K** – Disk Locks w/o Lock Panels

**J2** – Pin Locks with Lock Panels  
**K2** – Pin Locks w/o Lock Panels

**Lock schedule with keying arrangement must be furnished when locks are specified.** See page 10 & 11 for keying arrangement diagrams, and page 114-115 for sample lock schedule.

To specify Disk Locks without Lock Panels, add **K** to the end of the cabinet number.

Example: **E40W362236-1011K**  
(Added to all cupboards and drawers.)

To specify Pin Locks with Lock Panels, add **J2** to the end of the cabinet number.

Example: **E40W362236-1011J2**  
(Added to all cupboards and drawers.)

**Disk Tumbler Lock**  
(Medium Security)

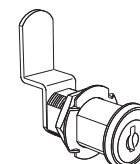

**Pin Tumbler Lock**  
(Higher Security)

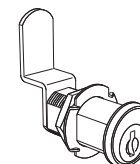

## Padlock Hasps

## Option L

Fabricated of Type 304 stainless steel. Includes a 2" square wear plate that mounts to the face of the drawer heads and doors to protect

them from wear and denting by the padlock. The L option adds Padlock Hasps and lock panels to all cupboards and drawers on the cabinet.

To specify Padlock Hasps, add **L** to the end of the cabinet number.

Example: **E40W362236-1011L**  
(Added to all cupboards and drawers.)

# Lock Keying Options

## Keyed Different

**Disk Tumbler Locks:** Available  
**Pin Tumbler Locks:** Available

All locks are keyed different from each other with individual keys for each lock. No key will open more than one lock.

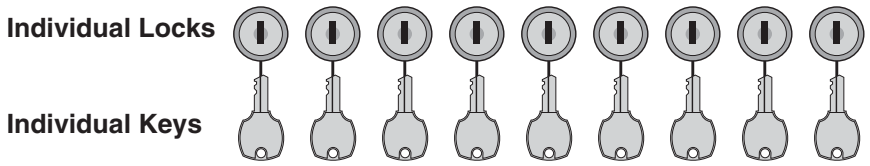

## Keyed Alike

**Disk Tumbler Locks:** Available  
**Pin Tumbler Locks:** Available

All locks are keyed alike. One key will open all locks.

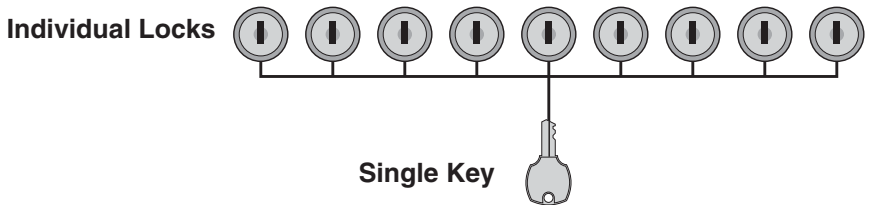

## Keyed Alike in Sets

**Disk Tumbler Locks:** Available  
**Pin Tumbler Locks:** Available

Locks are grouped into sets, with as many locks as needed in each set. All locks in a set can be opened by a single key, but that key can open no other locks. No key will open all locks.

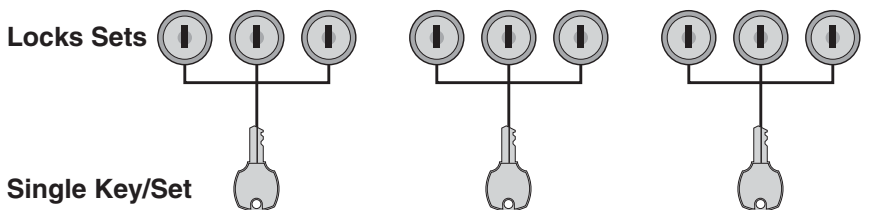

## Masterkeyed

**Disk Tumbler Locks:** Available  
**Pin Tumbler Locks:** Available

All locks are keyed different from each other with individual keys for each lock. Master key provided that can open all locks in the set. Multiple sets are available, but no key can open all locks in all sets.

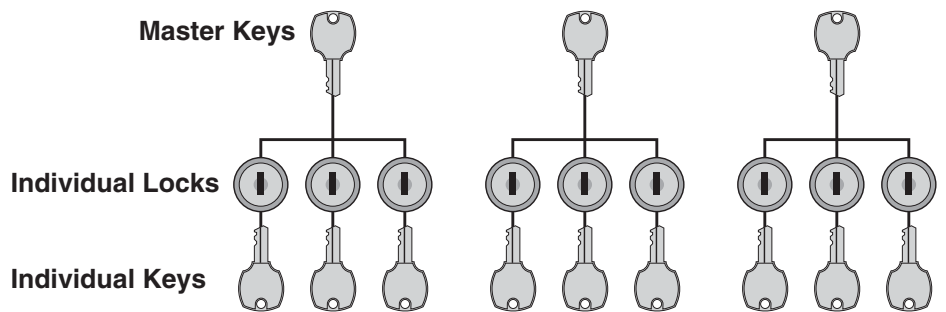

# Lock Keying Options

## Grand-masterkeyed

**Disk Tumbler Locks:** N/A  
**Pin Tumbler Locks:** Available

All locks are keyed different from each other with individual keys for each lock. Master key provided that can open all locks in the set. Multiple sets are available, with Grand-master key that can open all locks in all sets.

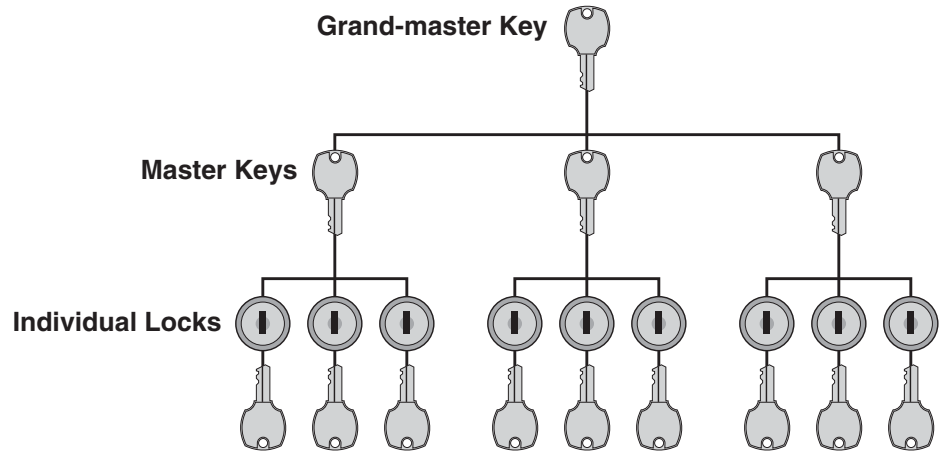

## Sub-masterkeyed & Mason Keyed

**Disk Tumbler Locks:** N/A  
**Pin Tumbler Locks:** Available

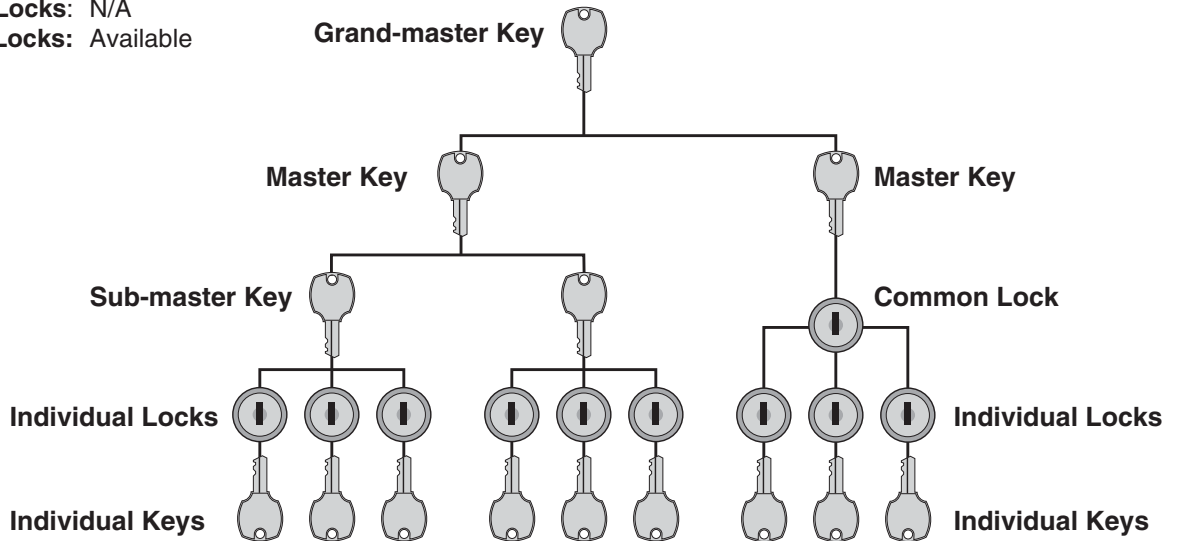

### Sub-masterkeyed

All locks are keyed different from each other with individual keys for each lock. Sub-master key provided that can open all locks in sub-set. Multiple sub-sets are available, with Master key that can open all locks in all sub-sets. Multiple sets are available, with Grand-master key that can open all locks in all sets and sub-sets.

### Mason Keyed

Locks are keyed different from each other with individual keys for each lock. Each individual key can also open all common locks in set. Master key provided that can open all locks in set. Multiple sets are available with Grand-master key that can open all locks in all sets.