

# Fume Hood Base Cabinets

## DIMENSIONAL VIEW

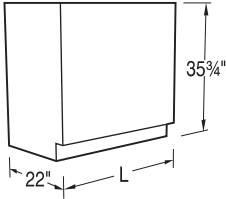

## Specifications

Standing Height Steel Fume Hood Base Cabinets are 35<sup>3</sup>/<sub>4</sub>" high and 22" deep; Wood Fume Hood Base Cabinets are 34<sup>3</sup>/<sub>4</sub>" high and a nominal 22" deep. ADA Height Steel Fume Hood Base Cabinets are 33" high and 22" deep; ADA Height Wood Fume Hood Base Cabinets are 32<sup>3</sup>/<sub>4</sub>" high and nominal 22" deep. Lengths as shown.

### Cabinet Style Option:

Specify cabinet door and hardware style when ordering by replacing blanks in last four digits of catalog number with style numbers. See the Research Collection Steel and Signature Series Wood Catalogs for available styles and details.

## Standing Height Fume Hood Base Cabinets

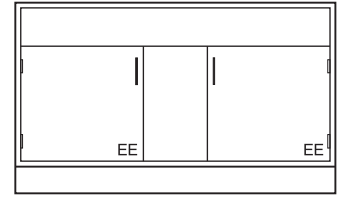
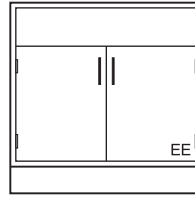
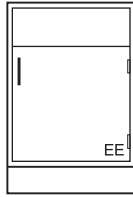
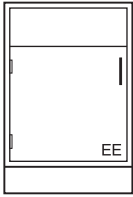

### Steel Cabinets

(35<sup>3</sup>/<sub>4</sub>" High)

G08M3712L	12"L	G08M3712-	12"L	G08M3730-	30"L	G08M3760-	60"L
G08M3715L	15"L	G08M3715-	15"L	G08M3736-	36"L		
G08M3718L	18"L	G08M3718-	18"L	G08M3748-	48"L		
G08M3724L	24"L	G08M3724-	24"L				

### Wood Cabinets

(34<sup>3</sup>/<sub>4</sub>" High)

G08H362212L	12"L	G08H362212-	12"L	G08H362230-	30"L	G08H362260-	60"L
G08H362215L	15"L	G08H362215-	15"L	G08H362236-	36"L		
G08H362218L	18"L	G08H362218-	18"L	G08H362248-	48"L		
G08H362224L	24"L	G08H362224-	24"L				

## ADA Height Fume Hood Base Cabinets

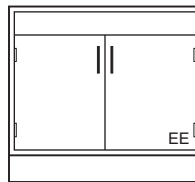
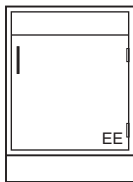
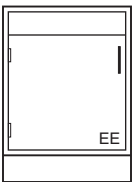

### Steel Cabinets

(33" High)

G08M3412L	12"L	G08M3412-	12"L	G08M3430-	30"L
G08M3415L	15"L	G08M3415-	15"L	G08M3436-	36"L
G08M3418L	18"L	G08M3418-	18"L	G08M3442-	42"L
G08M3424L	24"L	G08M3424-	24"L	G08M3448-	48"L

### Wood Cabinets

(32<sup>3</sup>/<sub>4</sub>" High)

G08H342212L	12"L	G08H342212-	12"L	G08H342230-	30"L
G08H342215L	15"L	G08H342215-	15"L	G08H342236-	36"L
G08H342218L	18"L	G08H342218-	18"L	G08H342242-	42"L
G08H342224L	24"L	G08H342224-	24"L	G08H342248-	48"L

# Solvent Storage Fume Hood Base Cabinets

## Specifications

Solvent Storage Cabinets are specifically designed for the storage of flammable and combustible liquids. Both steel and wood cabinets are UL listed and meet UFC, OSHA and NFPA No. 30-1993 construction standards.

A 2" deep, steel, liquid-tight pan covers the entire bottom to contain liquid leaks and spills. A second pan is provided as a full depth adjustable shelf.

Two diametrically opposed vents with spark screens are provided in the back for cases when ventilation is required.

The steel cabinet is all 18 gauge steel, double panel construction with self-closing doors, synchronized so that both doors will always fully close. The right hand door is equipped with a three-point latching system that automatically engages the cabinet

frame. Each door is equipped with a fusible-link hold-open feature that ensures the doors close should the temperature outside the cabinet exceed 165°F. Steel cabinets are provided with a grounding screw at the rear.

All Solvent Storage Cabinets are labeled: CAUTION FLAMMABLE – KEEP FIRE AWAY.

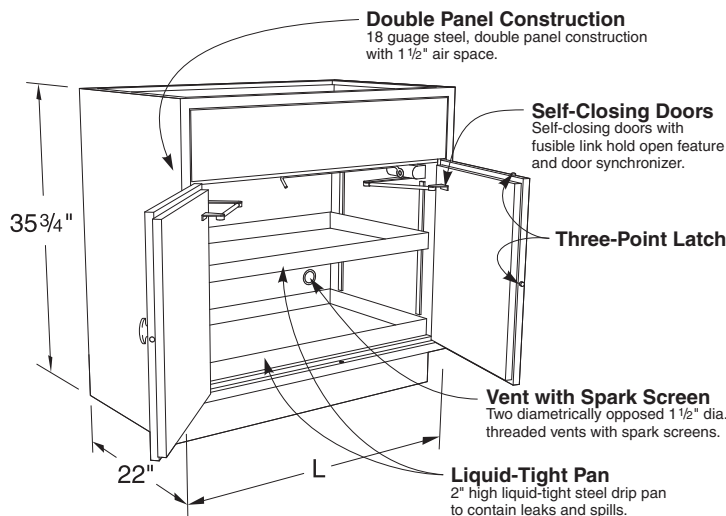
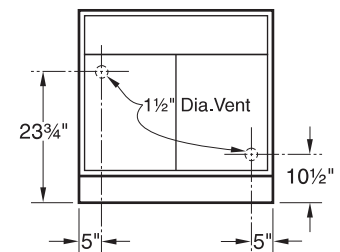

Illustration of Steel Standing Height Solvent Storage Cabinet

## Vent Locations



Vent outlets are 1 1/2" Male NPT

## Standing Height Solvent Storage Fume Hood Cabinets

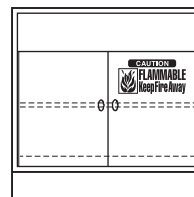
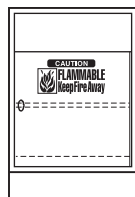
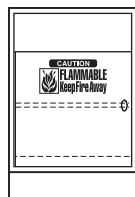

Steel Cabinets (35 3/4" High)		Capacity		Capacity	
G68M3724L0100	24"L	G68M3724-0100	24"L	10 gal	
		G68M3730-0100	30"L	12 gal	
		G68M3736-0100	36"L	15 gal	
		G68M3748-0100	48"L	20 gal	

Wood Cabinets (35" High)		Capacity		Capacity	
G68W362224L_0_0	24"L	G68W362224-_0_0	24"L	10 gal	
		G68W362230-_0_0	30"L	12 gal	
		G68W362236-_0_0	36"L	15 gal	
		G68W362248-_0_0	48"L	20 gal	

## ADA Height Solvent Storage Fume Hood Cabinets

Steel Cabinets (33" High)		Capacity		Capacity	
G68M3424L0100	24"L	G68M3424-0100	24"L	10 gal	
		G68M3430-0100	30"L	12 gal	
		G68M3436-0100	36"L	15 gal	
		G68M3448-0100	48"L	20 gal	

\* Check with factory on UL listing of Steel ADA Height Cabinets

Wood Cabinets (32 1/2" High)		Capacity		Capacity	
G68W342224L_0_0	24"L	G68W342224-_0_0	24"L	10 gal	
		G68W342230-_0_0	30"L	12 gal	
		G68W342236-_0_0	36"L	15 gal	
		G68W342248-_0_0	48"L	20 gal	

# Acid Storage Fume Hood Base Cabinets

## Specifications

Acid Storage Fume Hood Base Cabinets are specifically designed for the storage of corrosive chemicals. They are available in either steel or wood. These cabinets are lined with a molded one piece linear low density polyethylene tub with coved corners and a 1" lip at the bottom front. The

cabinet doors are lined with 1/8" sheet polyethylene and the doors are latched using a nylon roller catch. Each cabinet is furnished with a PVC vent pipe for venting to the fume hood above. (Requires a 2" hole in the hood worksurface.)

## Optional Removable Half-Depth Shelf

Part No.	
<b>019624</b>	Shelf for 24" cabinet
<b>019625</b>	Shelf for 30" cabinet
<b>019626</b>	Shelf for 36" cabinet
<b>019627</b>	Shelf for 48" cabinet

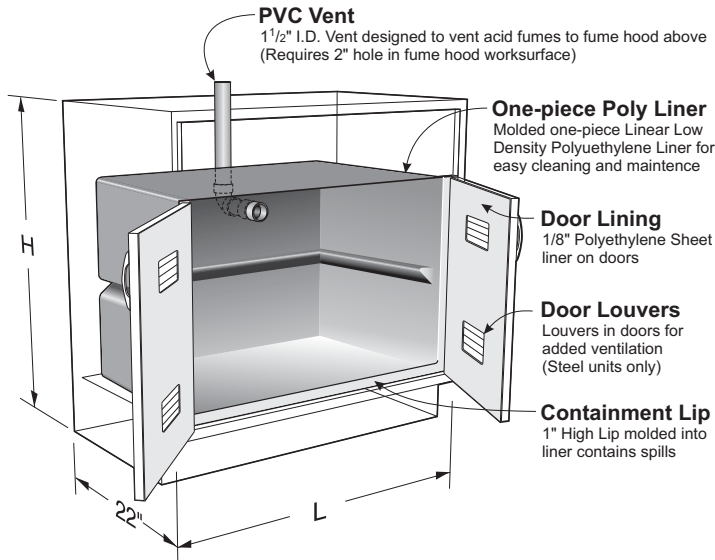
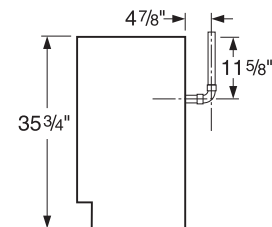

Illustration of Steel Standing Height Acid Storage Cabinet

## Vent Location



24" Cabinet	-	on Center
30" Cabinet	-	7 5/8" Right of Center
36" Cabinet	-	5" Right of Center
48" Cabinet	-	5" Right of Center
60" Cabinet	-	on Center

## Standing Height Acid Storage Fume Hood Cabinets

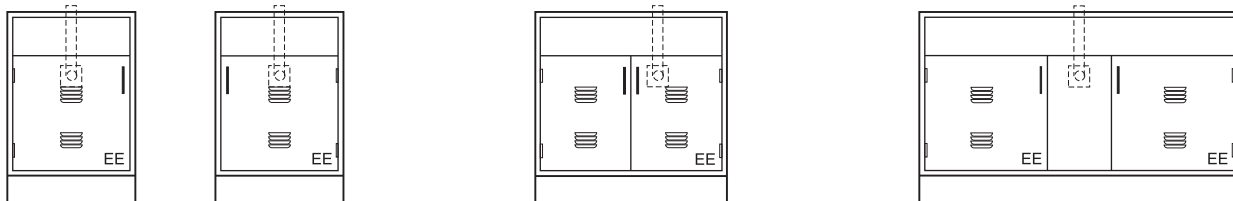

### Steel Cabinets (35 3/4" High)

**G80M3724L**\_\_\_\_\_ 24"L Left Hand  
**G80M3724-**\_\_\_\_\_ 24"L Right Hand

**G80M3730-**\_\_\_\_\_ 30"L  
**G80M3736-**\_\_\_\_\_ 36"L  
**G80M3748-**\_\_\_\_\_ 48"L

**G80M3760-**\_\_\_\_\_ 60"L

### Wood Cabinets (35" High)

**G80H372224L**\_\_\_\_\_ 24"L Left Hand  
**G80H372224-**\_\_\_\_\_ 24"L Right Hand

**G80H372230-**\_\_\_\_\_ 30"L  
**G80H372236-**\_\_\_\_\_ 36"L  
**G80H372248-**\_\_\_\_\_ 48"L

**G80H3760-**\_\_\_\_\_ 60"L

## ADA Height Acid Storage Fume Hood Cabinets

### Steel Cabinets (33" High)

**G80M3424L**\_\_\_\_\_ 24"L Left Hand  
**G80M3424-**\_\_\_\_\_ 24"L Right Hand

**G80M3430-**\_\_\_\_\_ 30"L  
**G80M3436-**\_\_\_\_\_ 36"L  
**G80M3448-**\_\_\_\_\_ 48"L

### Wood Cabinets (32 1/2" High)

**G80H342224L**\_\_\_\_\_ 24"L Left Hand  
**G80H342224-**\_\_\_\_\_ 24"L Right Hand

**G80H342230-**\_\_\_\_\_ 30"L  
**G80H342236-**\_\_\_\_\_ 36"L  
**G80H342248-**\_\_\_\_\_ 48"L

# Vacuum Pump Storage Base Cabinets

## Specifications

Vacuum Pump Storage Fume Hood Cabinets are designed without a bottom to allow vacuum pumps and other equipment to be rolled in or out of the cabinets. The interior is lined with 1" thick neoprene foam for sound deadening and easy cleaning. Each

cabinet is furnished with a 120 VAC, 20 amp, duplex receptacle mounted on the inside cabinet back and a pilot lighted toggle switch mounted in the top front rail. (Wiring is not included.) Cabinets are also furnished with a 1½" diameter PVC vent pipe for venting or

access to the hood above. (Requires a 2" hole in the hood worksurface.) The toespace rail is attached to the door to allow total access to the cabinet. Cabinet inside clearance at the floor is 16½" front-to-back, 27" high, and 3" less than the overall cabinet length.

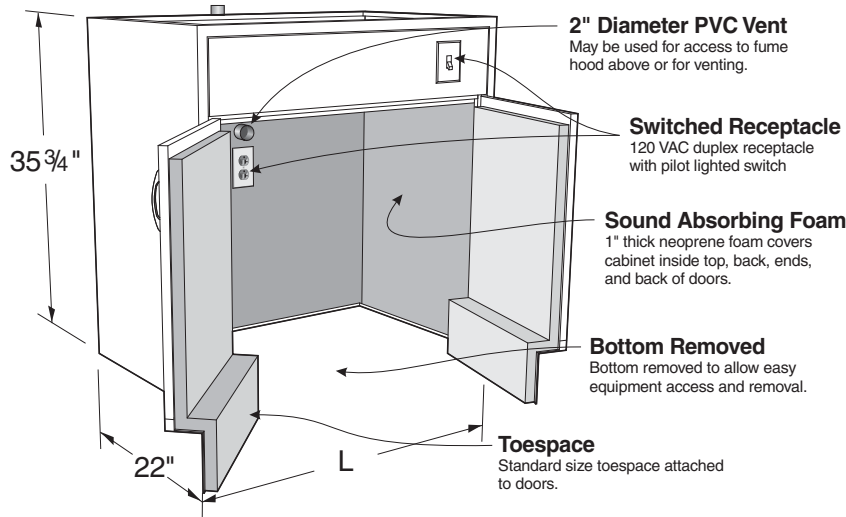

## Vent Location

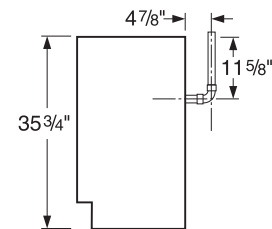

- 24" Cabinet – 5" off Center
- 30" Cabinet – on Center
- 36" Cabinet – on Center
- 48" Cabinet – on Center

## Standing Height Vacuum Pump Storage Fume Hood Cabinets

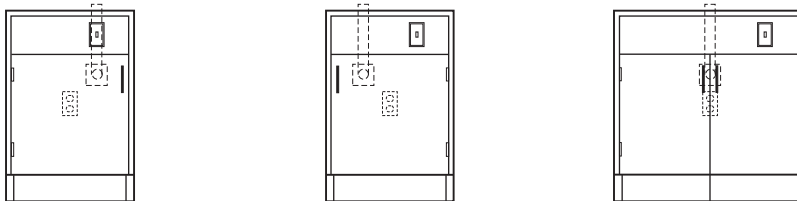

<b>Steel Cabinets</b> (35 3/4" High)		
G35M3724L ___ 24"L	G35M3724- ___ 24"L	G35M3730- ___ 30"L
		G35M3736- ___ 36"L
		G35M3748- ___ 48"L

<b>Wood Cabinets</b> (35" High)		
G35W362224L ___ 24"L	G35W362224- ___ 24"L	G35W362230- ___ 30"L
		G35W362236- ___ 36"L
		G35W362248- ___ 48"L

## ADA Height Vacuum Storage Fume Hood Cabinets

<b>Steel Cabinets</b> (33" High)		
G35M3424L ___ 24"L	G35M3424- ___ 24"L	G35M3430- ___ 30"L
		G35M3436- ___ 36"L
		G35M3448- ___ 48"L

<b>Wood Cabinets</b> (32 1/2" High)		
G35W342224L ___ 24"L	G35W342224- ___ 24"L	G35W342230- ___ 30"L
		G35W342236- ___ 36"L
		G35W342248- ___ 48"L

# Fume Hood Filters & Canopy Hoods

## Filter Housings and Filters

### Filter Housing

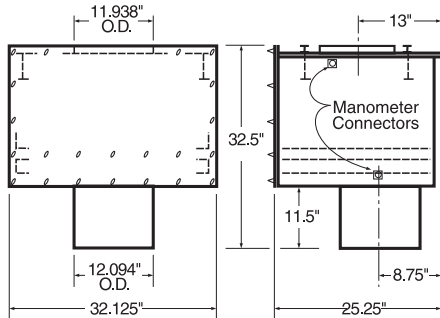

Filter Housings with Filters are designed to entrap and retain airborne contamination (usually radioactive) at their source or origin, rather than permitting them to circulate further through the exhaust duct and into the atmosphere. These filter housings are designed for use with one 2" thick pre-filter, and one 11½" thick high efficiency or charcoal filter. The housings are available in either painted, cold rolled steel or stainless steel and with an optional manometer connection.

Painted CRS	St. Steel	
<b>X-016869</b>	<b>X-016868</b>	Filter Housing
<b>X-016870</b>	<b>X-016871</b>	w/Manometer Connection

**Filters must be ordered separately.**

### High Efficiency Filter

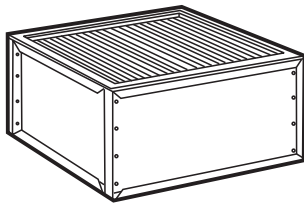

The high efficiency (HEPA absolute type) filter, has an efficiency of 99.7% for particles in the size range of 0.3 to 0.5 microns. The charcoal absorber filter, is designed for high efficiency removal of gaseous radioactive material. Both filters as well as the pre-filter are standard replaceable filters.

<b>0864-00</b>	High Efficiency Filter 11½" x 24" x 30"
<b>0855-00</b>	Charcoal Absorber 11½" x 24" x 30"

When High Efficiency Filters are used, exhaust fans should be sized for 3" or more static pressure to allow for dirt loading of the filters.

### Pre-Filter

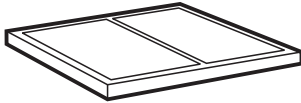

<b>0863-00</b>	Pre-Filter	2" x 24" x 30"
----------------	------------	----------------

## Canopy Hoods

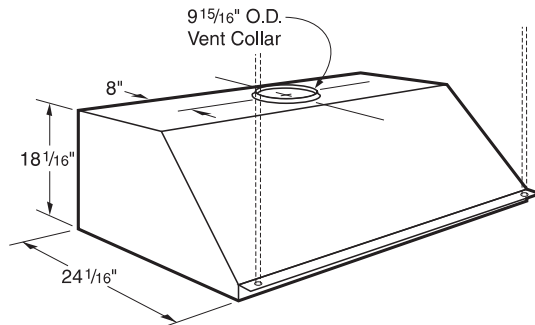

Canopy Hoods are useful for conducting heat out of laboratories, and can be mounted over tables where hot plates or other heat generating apparatus is located. They are fabricated of cold rolled steel, phosphate coated with a baked chemical resistant, synthetic resin finish, or of type 304 stainless steel. They are available 3 feet, 4 feet, 5 feet, 6 feet and 8 feet long. The painted steel canopies are available with or without a lining of ¼" thick KMER. Each canopy hood is furnished with a 9<sup>15</sup>/<sub>16</sub>" O.D. vent collar. (8 foot canopies are furnished with two duct collars, 48" on center.) (½" diameter support rods to the ceiling are not included.)

KMER Lined Painted Steel	Unlined Painted Steel	Unlined Stainless Steel	
<b>2B-2818-3K-M</b>	<b>2B-2818-30-M</b>	<b>2B-2818-30-S</b>	36"L
<b>2B-2818-4K-M</b>	<b>2B-2818-40-M</b>	<b>2B-2818-40-S</b>	48"L
<b>2B-2818-5K-M</b>	<b>2B-2818-50-M</b>	<b>2B-2818-50-S</b>	60"L
<b>2B-2818-6K-M</b>	<b>2B-2818-60-M</b>	<b>2B-2818-60-S</b>	72"L
<b>2B-2818-8K-M</b>	<b>2B-2818-80-M</b>	<b>2B-2818-80-S</b>	96"L